

49th STREET

435.0'

PARKING

PARKING

00B

00E

00A

00D

665.0'

PARKING

PLAYFIELD

00C

PAVED PLAY

605.0'

P03

PLAYFIELD

P01

435.0'

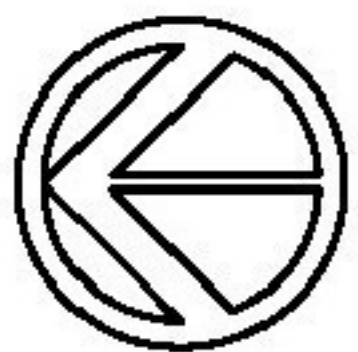

NORTH

SITE AREA: 6.06 ACRES
A.P.N. 011-0200-031

Marian Anderson Elementary School (111)
2850 49th Street
SACRAMENTO CITY UNIFIED SCHOOL DISTRICT

AHERA Management Plan

BLD 00A

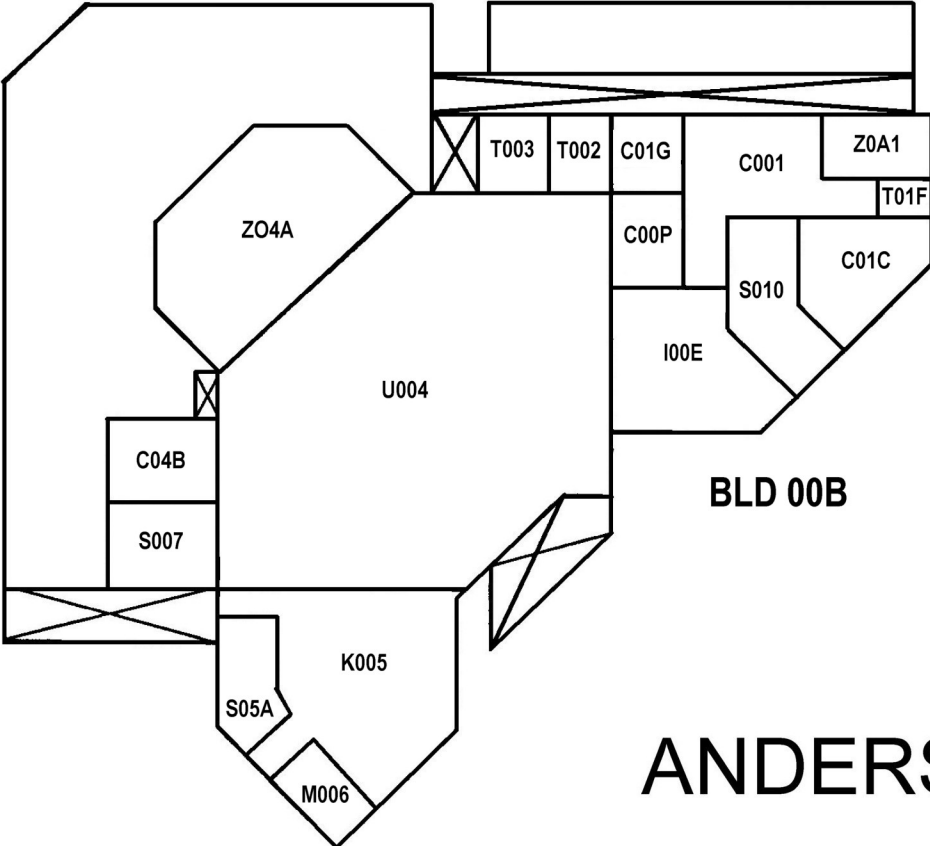
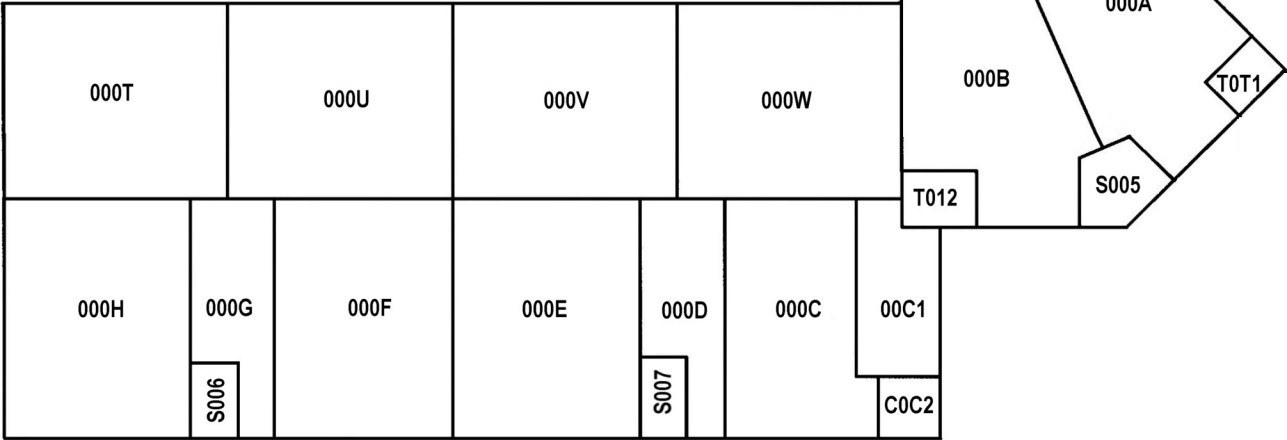

BLD 00B

ANDERSON



NORTH

DRAWING No.	1
SPACE	
FLOOR	1ST

BLD 00A

P00C

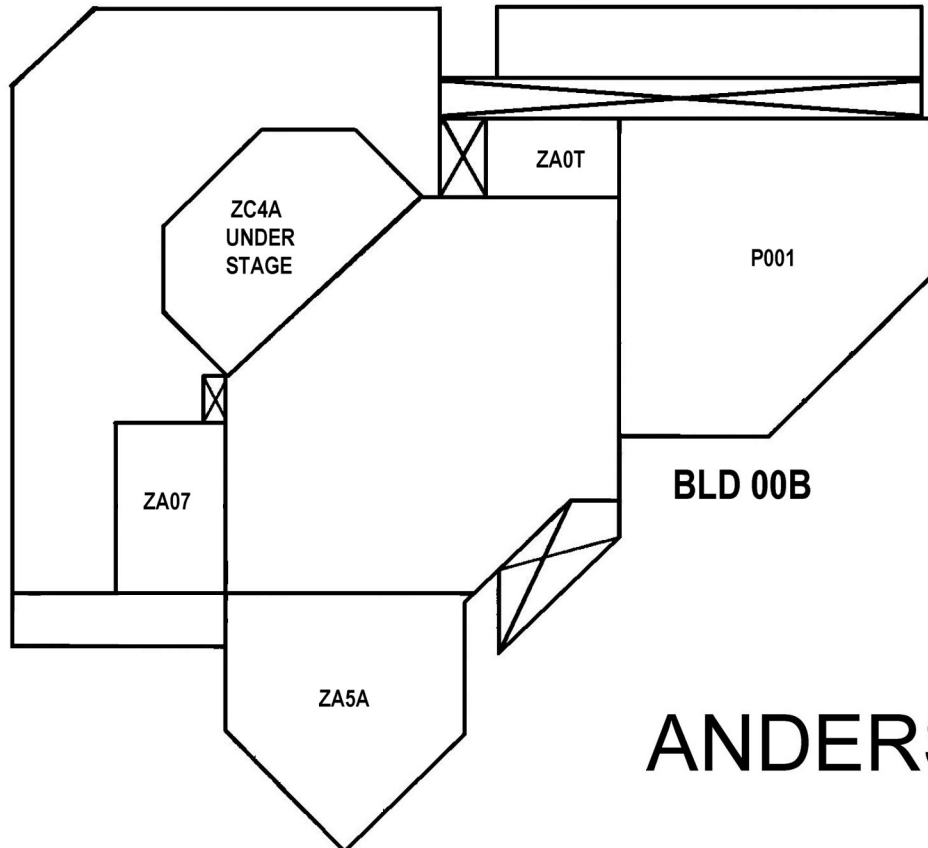

NORTH

ANDERSON

DRAWING No.	1A
SPACE	ATTIC & CRAWL
FLOOR	1ST

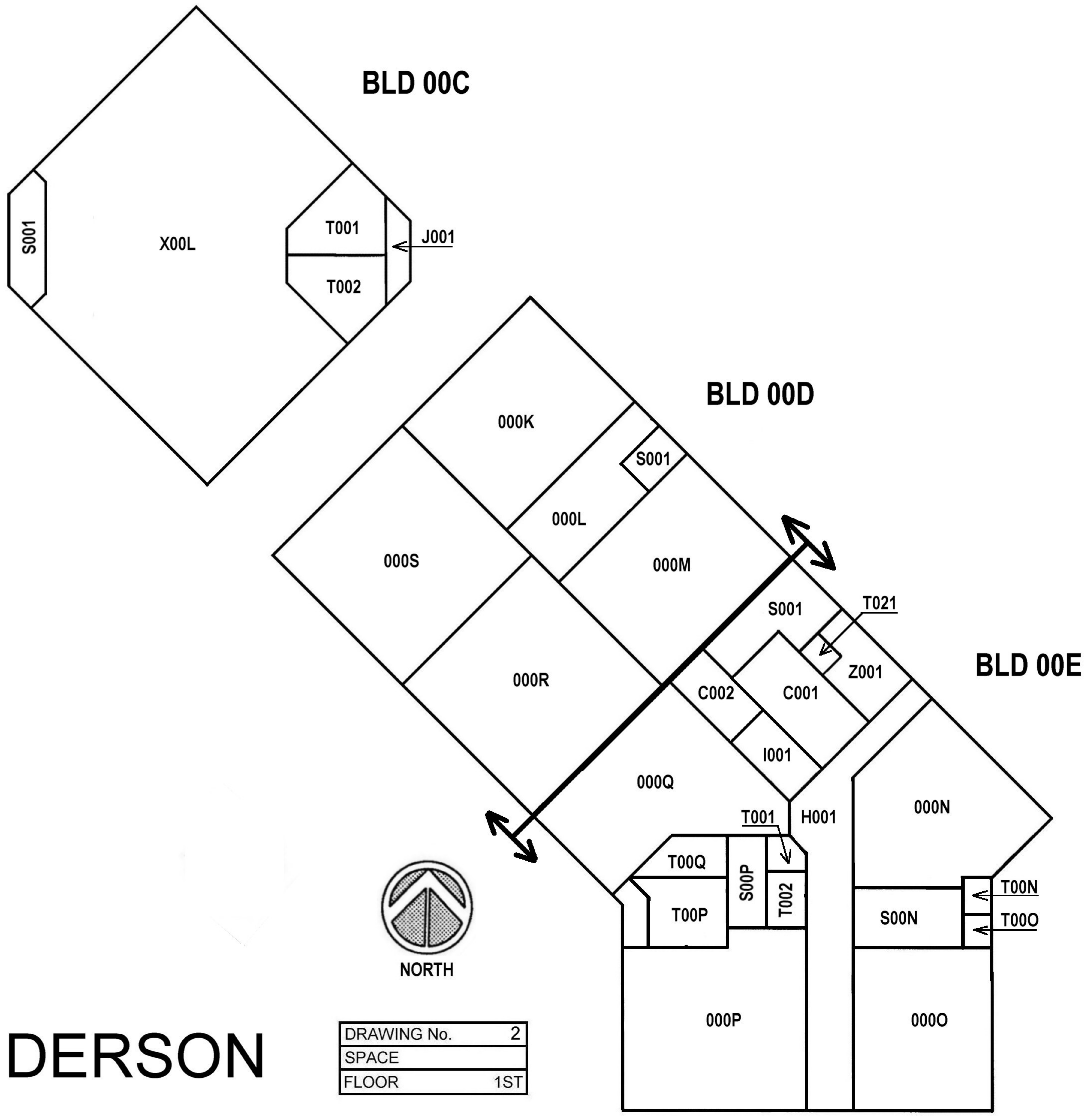

ANDERSON

DRAWING No.	2
SPACE	
FLOOR	1ST

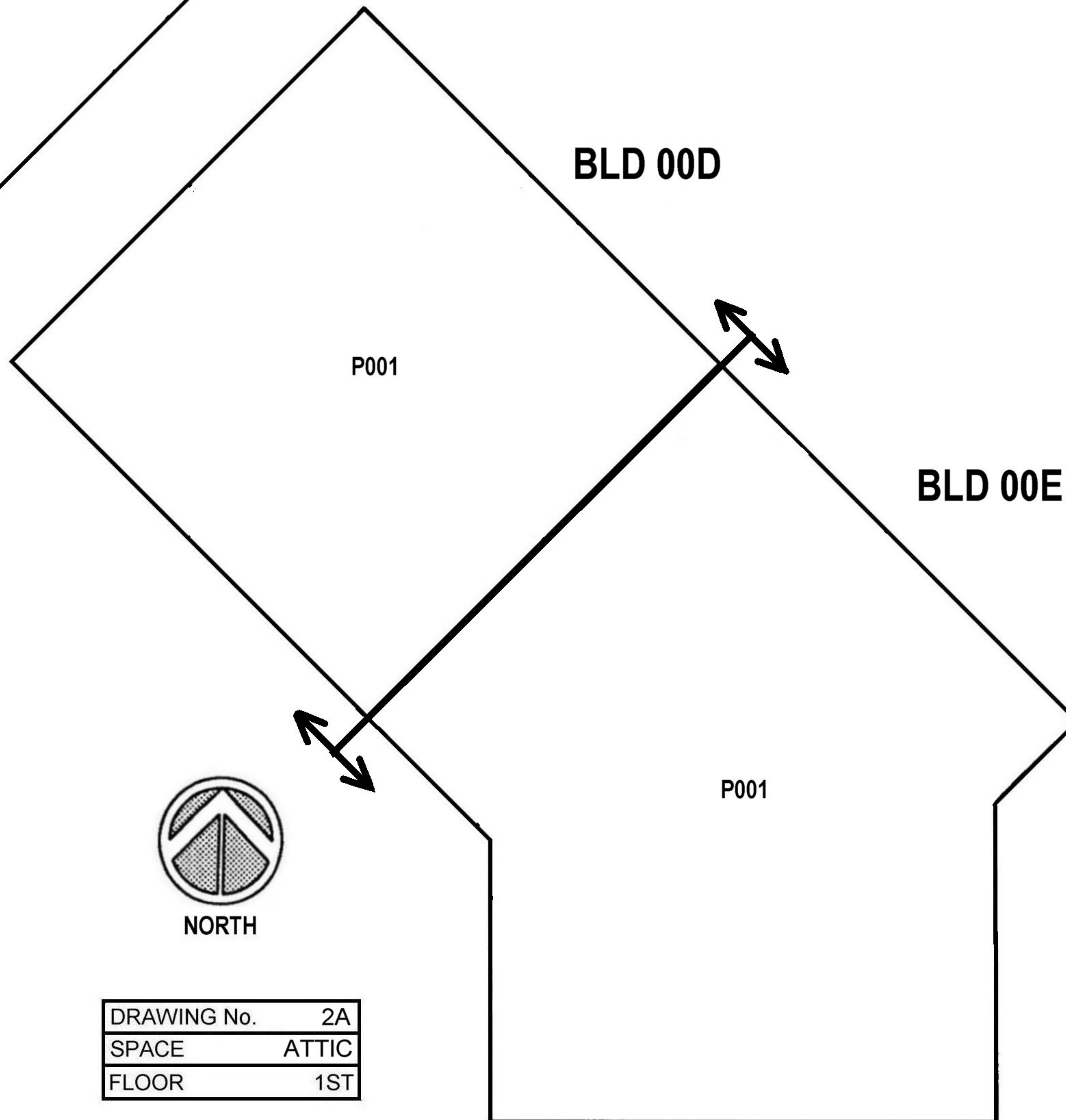
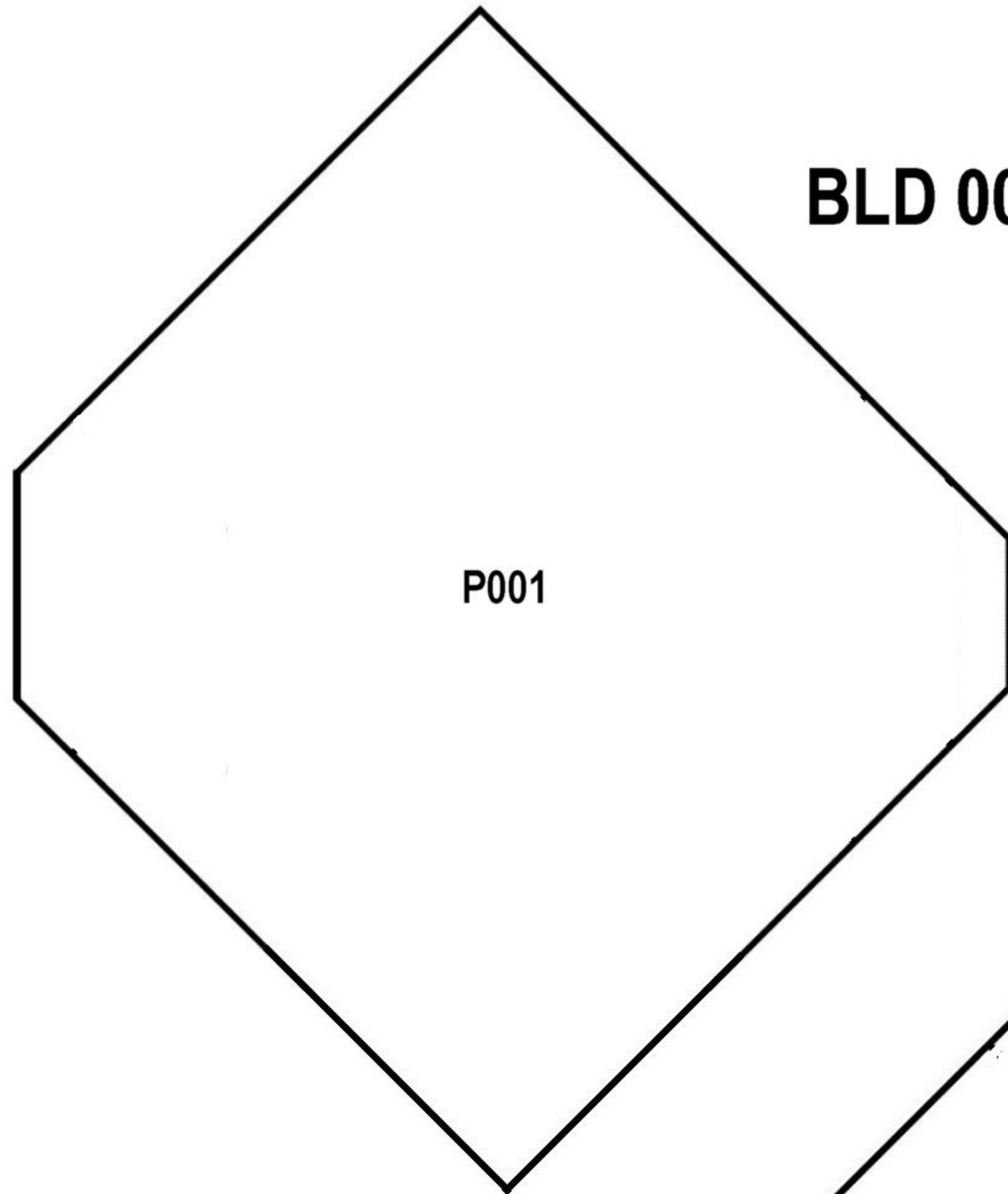

NORTH

ANDERSON

DRAWING No.	2A
SPACE	ATTIC
FLOOR	1ST

PLAY
AREA

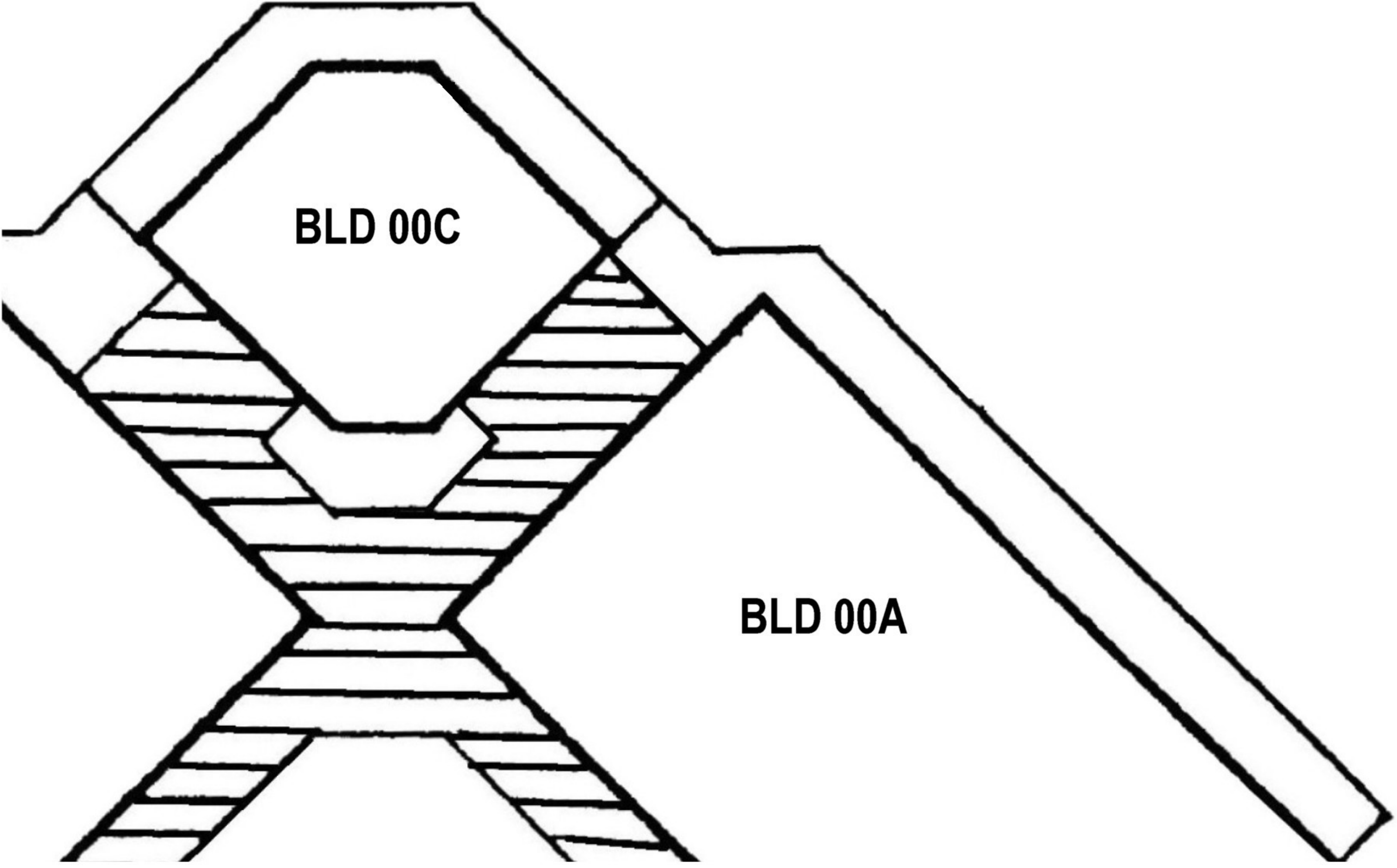

BLD P01

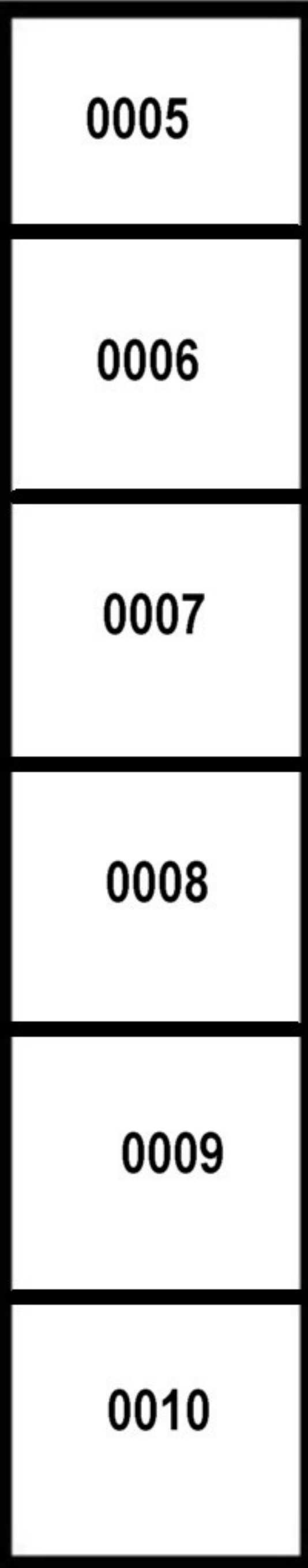

BLD P03

ANDERSON

DRAWING No.	3
SPACE	
FLOOR	1ST

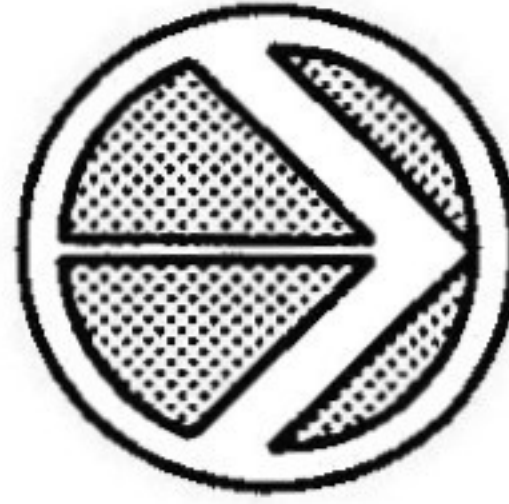

NORTH

SACRAMENTO CITY UNIFIED SCHOOL DISTRICT - AHERA 3 YEAR SUSPECT MATERIAL REPORT

DATE PRINTED: 7/1/2011 1

SITE: 111		MARIAN ANDERSON			Address: 2850 49TH STREET, Sacramento 95819				
Building No:	00A	Room	C0C2	Description	Office		Drawing No:	1	
Location	Homogeneous Material	Class	Friable	Material Size	Type of Asbestos	Sample Type	% Asbestos	Sample #	
Ceiling	Acoustical Tile, Lay In	M	N	0 SF	Non ASB	Sampled	0	006H00	
Flooring	Tile 12 In.	M	N	80 SF	Non ASB	Sampled	0	B1727	
Wall	Sheet Rock	M	N	0 SF	Non ASB	Sampled	0	003H01	

Building No:	00A	Room	O00A	Description	Classroom		Drawing No:	1	
Location	Homogeneous Material	Class	Friable	Material Size	Type of Asbestos	Sample Type	% Asbestos	Sample #	
Ceiling	Acoustical Tile, Lay In	M	N	0 SF	Non ASB	Sampled	0	006H01	
Flooring	Tile 12 In.	M	N	960 SF	Serp	Sampled	2	E3022	
Wall	Sheet Rock	M	N	0 SF	Non ASB	Sampled	0	003H00	

Building No:	00A	Room	O00B	Description	Classroom		Drawing No:	1	
Location	Homogeneous Material	Class	Friable	Material Size	Type of Asbestos	Sample Type	% Asbestos	Sample #	
Ceiling	Acoustical Tile, Lay In	M	N	0 SF	Non ASB	Sampled	0	006H01	
Flooring	Tile 12 In.	M	N	960 SF	Serp	Sampled	2	E3022	
Wall	Sheet Rock	M	N	0 SF	Non ASB	Sampled	0	003H00	

Building No:	00A	Room	O00C	Description	Classroom		Drawing No:	1	
Location	Homogeneous Material	Class	Friable	Material Size	Type of Asbestos	Sample Type	% Asbestos	Sample #	
Ceiling	Acoustical Tile, Lay In	M	N	0 SF	Non ASB	Sampled	0	006H00	
Flooring	Tile 12 In.	M	N	906 SF	Serp	Sampled	2	E3022	
Wall	Sheet Rock	M	N	0 SF	Non ASB	Sampled	0	003H00	

Building No:	00A	Room	O00D	Description	Classroom		Drawing No:	1	
Location	Homogeneous Material	Class	Friable	Material Size	Type of Asbestos	Sample Type	% Asbestos	Sample #	
Ceiling	Acoustical Tile, Lay In	M	N	0 SF	Non ASB	Sampled	0	006H00	
Flooring	Tile 12 In.	M	N	30 SF	Non ASB	Sampled	0	B1727	
Wall	Sheet Rock	M	N	0 SF	Non ASB	Sampled	0	003H00	

SACRAMENTO CITY UNIFIED SCHOOL DISTRICT - AHERA 3 YEAR SUSPECT MATERIAL REPORT

DATE PRINTED: 7/1/2011 1

SITE: 111		MARIAN ANDERSON				Address: 2850 49TH STREET, Sacramento 95819				
Building No:	00A	Room	O00E	Description	Classroom		Drawing No:	1		
Location	Homogeneous Material	Class	Friable	Material Size		Type of Asbestos	Sample Type	% Asbestos	Sample #	
Ceiling	Acoustical Tile, Lay In	M	N	0	SF	Non ASB	Sampled	0	006H00	
Flooring	Tile 12 In.	M	N	960	SF	Serp	Sampled	2	E3022	
Wall	Sheet Rock	M	N	0	SF	Non ASB	Sampled	0	003H00	

Building No:	00A	Room	O00F	Description	Classroom		Drawing No:	1		
Location	Homogeneous Material	Class	Friable	Material Size		Type of Asbestos	Sample Type	% Asbestos	Sample #	
Ceiling	Acoustical Tile, Lay In	M	N	0	SF	Non ASB	Sampled	0	006H00	
Flooring	Tile 12 In.	M	N	960	SF	Serp	Sampled	2	E3022	
Wall	Sheet Rock	M	N	0	SF	Non ASB	Sampled	0	003H00	

Building No:	00A	Room	O00G	Description	Classroom		Drawing No:	1		
Location	Homogeneous Material	Class	Friable	Material Size		Type of Asbestos	Sample Type	% Asbestos	Sample #	
Ceiling	Acoustical Tile, Lay In	M	N	0	SF	Non ASB	Sampled	0	006H00	
Wall	Sheet Rock	M	N	0	SF	Non ASB	Sampled	0	003H00	

Building No:	00A	Room	O00H	Description	Classroom		Drawing No:	1		
Location	Homogeneous Material	Class	Friable	Material Size		Type of Asbestos	Sample Type	% Asbestos	Sample #	
Ceiling	Acoustical Tile, Lay In	M	N	0	SF	Non ASB	Sampled	0	006H01	
Flooring	Tile 12 In.	M	N	960	SF	Serp	Sampled	2	E3022	
Wall	Sheet Rock	M	N	0	SF	Non ASB	Sampled	0	003H00	

Building No:	00A	Room	O00T	Description	Classroom		Drawing No:	1		
Location	Homogeneous Material	Class	Friable	Material Size		Type of Asbestos	Sample Type	% Asbestos	Sample #	
Ceiling	Acoustical Tile, Lay In	M	N	0	SF	Non ASB	Sampled	0	006H00	
Flooring	Tile 12 In.	M	N	960	SF	Serp	Sampled	2	E3022	
Wall	Sheet Rock	M	N	0	SF	Non ASB	Sampled	0	003H00	

SACRAMENTO CITY UNIFIED SCHOOL DISTRICT - AHERA 3 YEAR SUSPECT MATERIAL REPORT

DATE PRINTED: 7/1/2011 1

SITE: 111		MARIAN ANDERSON			Address: 2850 49TH STREET, Sacramento 95819				
Building No:	00A	Room	000U	Description	Classroom		Drawing No:	1	
Location	Homogeneous Material	Class	Friable	Material Size	Type of Asbestos	Sample Type	% Asbestos	Sample #	
Ceiling	Acoustical Tile, Lay In	M	N	0 SF	Non ASB	Sampled	0	006H00	
Flooring	Tile 12 In.	M	N	960 SF	Serp	Sampled	2	E3022	
Wall	Sheet Rock	M	N	0 SF	Non ASB	Sampled	0	003H00	

Building No:	00A	Room	000V	Description	Classroom		Drawing No:	1	
Location	Homogeneous Material	Class	Friable	Material Size	Type of Asbestos	Sample Type	% Asbestos	Sample #	
Ceiling	Acoustical Tile, Lay In	M	N	0 SF	Non ASB	Sampled	0	006H00	
Flooring	Tile 12 In.	M	N	960 SF	Serp	Sampled	2	E3022	
Wall	Sheet Rock	M	N	0 SF	Non ASB	Sampled	0	003H00	

Building No:	00A	Room	000W	Description	Classroom		Drawing No:	1	
Location	Homogeneous Material	Class	Friable	Material Size	Type of Asbestos	Sample Type	% Asbestos	Sample #	
Ceiling	Acoustical Tile, Lay In	M	N	0 SF	Non ASB	Sampled	0	006H00	
Flooring	Tile 12 In.	M	N	960 SF	Serp	Sampled	2	E3022	
Wall	Sheet Rock	M	N	0 SF	Non ASB	Sampled	0	003H00	

Building No:	00A	Room	00C1	Description	Classroom		Drawing No:	1	
Location	Homogeneous Material	Class	Friable	Material Size	Type of Asbestos	Sample Type	% Asbestos	Sample #	
Ceiling	Acoustical Tile, Lay In	M	N	0 SF	Non ASB	Sampled	0	006H00	
Flooring	Tile 12 In.	M	N	200 SF	Non ASB	Sampled	0	B1727	
Wall	Sheet Rock	M	N	0 SF	Non ASB	Sampled	0	003H00	

Building No:	00A	Room	P00C	Description	Plenum		Drawing No:	1A	
Location	Homogeneous Material	Class	Friable	Material Size	Type of Asbestos	Sample Type	% Asbestos	Sample #	
Attic	Attic Insulation	M	N	10000 SF	Non ASB	Sampled	0	B1721	
HVAC	Duct Seal	M	N	0 SF	Non ASB	Sampled	0	003H09	

Building No:	00A	Room	S005	Description	Storage		Drawing No:	1	
Location	Homogeneous Material	Class	Friable	Material Size	Type of Asbestos	Sample Type	% Asbestos	Sample #	
Ceiling	Sheet Rock	M	N	0 SF	Non ASB	Sampled	0	003H01	
Wall	Sheet Rock	M	N	0 SF	Non ASB	Sampled	0	003H00	

SACRAMENTO CITY UNIFIED SCHOOL DISTRICT - AHERA 3 YEAR SUSPECT MATERIAL REPORT

DATE PRINTED: 7/1/2011 1

SITE: 111 **MARIAN ANDERSON** **Address: 2850 49TH STREET, Sacramento 95819**

Building No: 00A **Room** **S006** **Description** **Storage** **Drawing No: 1**

Location	Homogeneous Material	Class	Friable	Material Size	Type of Asbestos	Sample Type	% Asbestos	Sample #
Ceiling	Acoustical Tile, Lay In	M	N	120 SF	Non ASB	Sampled	0	R2151
Ceiling	Sheet Rock	M	N	64 SF	Non ASB	Sampled	0	003H01
Wall	Sheet Rock	M	N	380 SF	Non ASB	Sampled	0	R2120

Building No: 00A **Room** **S007** **Description** **Storage** **Drawing No: 1**

Location	Homogeneous Material	Class	Friable	Material Size	Type of Asbestos	Sample Type	% Asbestos	Sample #
Ceiling	Acoustical Tile, Lay In	M	N	120 SF	Non ASB	Sampled	0	R2151
Wall	Sheet Rock	M	N	380 SF	Non ASB	Sampled	0	R2120

Building No: 00A **Room** **T0T1** **Description** **Toilet** **Drawing No: 1**

Location	Homogeneous Material	Class	Friable	Material Size	Type of Asbestos	Sample Type	% Asbestos	Sample #
Ceiling	Sheet Rock	M	N	0 SF	Non ASB	Sampled	0	003H01
Flooring	Mastic	M	N	SF	Non ASB	Sampled	0	J1208
Flooring	Vinyl Sheet	M	N	SF	Non ASB	Sampled	0	J1208
Wall	Sheet Rock	M	N	0 SF	Non ASB	Sampled	0	003H00

Building No: 00A **Room** **T0T2** **Description** **Toilet** **Drawing No: 1**

Location	Homogeneous Material	Class	Friable	Material Size	Type of Asbestos	Sample Type	% Asbestos	Sample #
Ceiling	Sheet Rock	M	N	0 SF	Non ASB	Sampled	0	003H01
Flooring	Mastic	M	N	SF	Non ASB	Sampled	0	J1208
Flooring	Vinyl Sheet	M	N	70 SF	Non ASB	Sampled	0	J1208
Wall	Sheet Rock	M	N	0 SF	Non ASB	Sampled	0	003H00

Building No: 00A **Room** **ZEXT** **Description** **Exterior** **Drawing No: 1**

Location	Homogeneous Material	Class	Friable	Material Size	Type of Asbestos	Sample Type	% Asbestos	Sample #
Exterior, Wall	Plaster	S	N	5000 SF	Non ASB	Sampled	0	E3019
Fitting	Heat Hot Water Insulation	T	N	0 LF	Non ASB	Sampled	0	E3039

SACRAMENTO CITY UNIFIED SCHOOL DISTRICT - AHERA 3 YEAR SUSPECT MATERIAL REPORT

DATE PRINTED: 7/1/2011 1

SITE: 111		MARIAN ANDERSON				Address: 2850 49TH STREET, Sacramento 95819				
Building No:	00B	Room	C001	Description	Office		Drawing No:	1		
Location	Homogeneous Material		Class	Friable	Material Size		Type of Asbestos	Sample Type	% Asbestos	Sample #
Ceiling	Acoustical Tile, Lay In		M	N	0 SF		Non ASB	Sampled	0	006B00
Flooring	Vinyl Sheet		M	N	36 SF		Non ASB	Sampled	0	R2166
HVAC	Duct Seal		M	N	0 SF		Non ASB	Sampled	0	008H00
Wall	Sheet Rock		M	N	900 SF		Non ASB	Sampled	0	003H03

Building No:	00B	Room	C00P	Description	Office		Drawing No:	1		
Location	Homogeneous Material		Class	Friable	Material Size		Type of Asbestos	Sample Type	% Asbestos	Sample #
Ceiling	Acoustical Tile, Lay In		M	N	0 SF		Non ASB	Sampled	0	006H01
Wall	Sheet Rock		M	N	0 SF		Non ASB	Sampled	0	003H03

Building No:	00B	Room	C01C	Description	Office		Drawing No:	1		
Location	Homogeneous Material		Class	Friable	Material Size		Type of Asbestos	Sample Type	% Asbestos	Sample #
Ceiling	Sheet Rock		M	N	0 SF		Non ASB	Sampled	0	003H03
Wall	Sheet Rock		M	N	0 SF		Non ASB	Sampled	0	003H03

Building No:	00B	Room	C01G	Description	Office		Drawing No:	1		
Location	Homogeneous Material		Class	Friable	Material Size		Type of Asbestos	Sample Type	% Asbestos	Sample #
Ceiling	Sheet Rock		M	N	0 SF		Non ASB	Sampled	0	003H03
Wall	Sheet Rock		M	N	0 SF		Non ASB	Sampled	0	003H03

Building No:	00B	Room	C04B	Description	Office		Drawing No:	1		
Location	Homogeneous Material		Class	Friable	Material Size		Type of Asbestos	Sample Type	% Asbestos	Sample #
Ceiling	Sheet Rock		M	N	0 SF		Non ASB	Sampled	0	003H02
Flooring	Tile 12 In.		M	N	180 SF		Serp	Sampled	2	B3018
Wall	Sheet Rock		M	N	0 SF		Non ASB	Sampled	0	003H03

Building No:	00B	Room	I00E	Description	Lounge		Drawing No:	1		
Location	Homogeneous Material		Class	Friable	Material Size		Type of Asbestos	Sample Type	% Asbestos	Sample #
Ceiling	Acoustical Tile, Lay In		M	N	0 SF		Non ASB	Sampled	0	006H01
Wall	Fire Rated Door		M	N	21 SF		Other	Assumed	N/A	
Wall	Sheet Rock		M	N	0 SF		Non ASB	Sampled	0	003H02

SACRAMENTO CITY UNIFIED SCHOOL DISTRICT - AHERA 3 YEAR SUSPECT MATERIAL REPORT

DATE PRINTED: 7/1/2011 1

SITE: 111	MARIAN ANDERSON				Address: 2850 49TH STREET, Sacramento 95819					
Building No: 00B	Room K005	Description Kitchen			Drawing No: 1					
Location	Homogeneous Material	Class	Friable	Material Size	Type of Asbestos	Sample Type	% Asbestos	Sample #		
Ceiling	Sheet Rock	M	N	0 SF	Non ASB	Sampled	0	003H02		
Flooring	Tile 12 In.	M	N	900 SF	Serp	Sampled	2	B3018		
Wall	Sheet Rock	M	N	0 SF	Non ASB	Sampled	0	003H00		

Building No: 00B	Room M006	Description Mechanical Room			Drawing No: 1					
Location	Homogeneous Material	Class	Friable	Material Size	Type of Asbestos	Sample Type	% Asbestos	Sample #		
Ceiling	Sheet Rock	M	N	0 SF	Non ASB	Sampled	0	003H03		
Wall	Sheet Rock	M	N	0 SF	Non ASB	Sampled	0	003H00		

Building No: 00B	Room P001	Description Plenum			Drawing No: 1A					
Location	Homogeneous Material	Class	Friable	Material Size	Type of Asbestos	Sample Type	% Asbestos	Sample #		
Attic	Attic Insulation	M	N	400 SF	Non ASB	Sampled	0	B1721		
HVAC	Duct Seal	M	N	0 SF	Non ASB	Sampled	0	008H00		
Wall	Sheet Rock	M	N	0 SF	Non ASB	Sampled	0	003H02		

Building No: 00B	Room S007	Description Storage			Drawing No: 1					
Location	Homogeneous Material	Class	Friable	Material Size	Type of Asbestos	Sample Type	% Asbestos	Sample #		
Ceiling	Sheet Rock	M	N	0 SF	Non ASB	Sampled	0	0030H2		
Wall	Sheet Rock	M	N	0 SF	Non ASB	Sampled	0	003H03		

Building No: 00B	Room S01D	Description Storage			Drawing No: 1					
Location	Homogeneous Material	Class	Friable	Material Size	Type of Asbestos	Sample Type	% Asbestos	Sample #		
Ceiling	Acoustical Tile, Splined	M	N	128 SF	Non ASB	Sampled	0	R2172		
Ceiling	Sheet Rock	M	N	0 SF	Non ASB	Sampled	0	003H03		
Wall	Sheet Rock	M	N	0 SF	Non ASB	Sampled	0	003H03		

Building No: 00B	Room S05A	Description Storage			Drawing No: 1					
Location	Homogeneous Material	Class	Friable	Material Size	Type of Asbestos	Sample Type	% Asbestos	Sample #		
Ceiling	Sheet Rock	M	N	0 SF	Non ASB	Sampled	0	003H02		
Flooring	Tile 12 In.	M	N	280 SF	Serp	Sampled	2	B3018		
Wall	Sheet Rock	M	N	0 SF	Non ASB	Sampled	0	003H02		

SACRAMENTO CITY UNIFIED SCHOOL DISTRICT - AHERA 3 YEAR SUSPECT MATERIAL REPORT

DATE PRINTED: 7/1/2011 1

Page 7 of 19

SITE: 111 **MARIAN ANDERSON** **Address: 2850 49TH STREET, Sacramento 95819**

Building No: 00B **Room T002** **Description Toilet** **Drawing No: 1**

Location	Homogeneous Material	Class	Friable	Material Size	Type of Asbestos	Sample Type	% Asbestos	Sample #
Ceiling	Sheet Rock	M	N	0 SF	Non ASB	Sampled	0	003H04
Wall	Sheet Rock	M	N	0 SF	Non ASB	Sampled	0	003H03

Building No: 00B **Room T003** **Description Toilet** **Drawing No: 1**

Location	Homogeneous Material	Class	Friable	Material Size	Type of Asbestos	Sample Type	% Asbestos	Sample #
Ceiling	Sheet Rock	M	N	0 SF	Non ASB	Sampled	0	003H02
Wall	Sheet Rock	M	N	0 SF	Non ASB	Sampled	0	003H02

Building No: 00B **Room T01F** **Description Toilet** **Drawing No: 1**

Location	Homogeneous Material	Class	Friable	Material Size	Type of Asbestos	Sample Type	% Asbestos	Sample #
Ceiling	Sheet Rock	M	N	0 SF	Non ASB	Sampled	0	003H02
Flooring	Vinyl Sheet	M	N	80 SF	Serp	Sampled	20	J1207
Wall	Sheet Rock	M	N	0 SF	Non ASB	Sampled	0	003H03

Building No: 00B **Room U004** **Description Multipurpose/Cafeteria** **Drawing No: 1**

Location	Homogeneous Material	Class	Friable	Material Size	Type of Asbestos	Sample Type	% Asbestos	Sample #
Flooring	Tile 12 In.	M	N	1200 SF	Serp	Sampled	2	B3018
Wall	Acoustical Tile, Splined	M	N	737 SF	Non ASB	Sampled	0	R2141
Wall	Fire Rated Door	M	N	21 SF	Other	Assumed	N/A	
Wall	Sheet Rock	M	N	0 SF	Non ASB	Sampled	0	003H03

Building No: 00B **Room Z04A** **Description Stage** **Drawing No: 1**

Location	Homogeneous Material	Class	Friable	Material Size	Type of Asbestos	Sample Type	% Asbestos	Sample #
Ceiling	Acoustical Tile, Lay In	M	N	0 SF	Non ASB	Sampled	0	006B00
Flooring	Vinyl Sheet	M	N	40 SF	Non ASB	Sampled	0	B1724
Wall	Fire Rated Door	M	N	21 SF	Other	Assumed	N/A	
Wall	Sheet Rock	M	N	0 SF	Non ASB	Sampled	0	003H00

SACRAMENTO CITY UNIFIED SCHOOL DISTRICT - AHERA 3 YEAR SUSPECT MATERIAL REPORT

DATE PRINTED: 7/1/2011 1

SITE: 111 **MARIAN ANDERSON** **Address: 2850 49TH STREET, Sacramento 95819**

Building No: 00B **Room** **Z0A1** **Description** **Misc. Room** **Drawing No: 2**

Location	Homogeneous Material	Class	Friable	Material Size	Type of Asbestos	Sample Type	% Asbestos	Sample #
Ceiling	Acoustical Tile, Lay In	M	N	0 SF	Non ASB	Sampled	0	006B00
Wall	Sheet Rock	M	N	0 SF	Non ASB	Sampled	0	003H00

Building No: 00B **Room** **ZA07** **Description** **Attic** **Drawing No: 1A**

Location	Homogeneous Material	Class	Friable	Material Size	Type of Asbestos	Sample Type	% Asbestos	Sample #
Attic	Attic Insulation	M	N	400 SF	Non ASB	Sampled	0	B1821

Building No: 00B **Room** **ZA0T** **Description** **Attic** **Drawing No: 1A**

Location	Homogeneous Material	Class	Friable	Material Size	Type of Asbestos	Sample Type	% Asbestos	Sample #
Attic	Attic Insulation	M	N	400 SF	Non ASB	Sampled	0	B1721
Wall	Sheet Rock	M	N	0 SF	Non ASB	Sampled	0	003H00

Building No: 00B **Room** **ZA5A** **Description** **Attic** **Drawing No: 1A**

Location	Homogeneous Material	Class	Friable	Material Size	Type of Asbestos	Sample Type	% Asbestos	Sample #
Attic	Attic Insulation	M	N	400 SF	Non ASB	Sampled	0	B1721
HVAC	Duct Seal	M	N	0 SF	Non ASB	Sampled	0	008B00

Building No: 00B **Room** **ZC4A** **Description** **Crawl Space** **Drawing No: 1A**

Location	Homogeneous Material	Class	Friable	Material Size	Type of Asbestos	Sample Type	% Asbestos	Sample #
Wall	Sheet Rock	M	N	0 SF	Non ASB	Sampled	0	003H02

Building No: 00B **Room** **ZEXT** **Description** **Exterior** **Drawing No: 1**

Location	Homogeneous Material	Class	Friable	Material Size	Type of Asbestos	Sample Type	% Asbestos	Sample #
Exterior, Wall	Asbestos Cement Panel	M	N	30 SF	Other	Assumed	N/A	
Exterior, Wall	Plaster	S	N	4000 SF	Non ASB	Sampled	0	E3023
Fitting	Heat Hot Water Insulation	T	N	0 LF	Non ASB	Sampled	0	E3040

SACRAMENTO CITY UNIFIED SCHOOL DISTRICT - AHERA 3 YEAR SUSPECT MATERIAL REPORT

DATE PRINTED: 7/1/2011 1

SITE: 111 **MARIAN ANDERSON** **Address: 2850 49TH STREET, Sacramento 95819**

Building No: 00C **Room J001** **Description Custodial Closet** **Drawing No: 2**

Location	Homogeneous Material	Class	Friable	Material Size	Type of Asbestos	Sample Type	% Asbestos	Sample #
Ceiling	Sheet Rock	M	N	0 SF	Non ASB	Sampled	0	003H05
Wall	Sheet Rock	M	N	0 SF	Non ASB	Sampled	0	003H05

Building No: 00C **Room P001** **Description Plenum** **Drawing No: 2A**

Location	Homogeneous Material	Class	Friable	Material Size	Type of Asbestos	Sample Type	% Asbestos	Sample #
Attic	Attic Insulation	M	N	2000 SF	Non ASB	Sampled	0	B1721
HVAC	Duct Seal	M	N	0 SF	Non ASB	Sampled	0	

Building No: 00C **Room S001** **Description Storage** **Drawing No: 2**

Location	Homogeneous Material	Class	Friable	Material Size	Type of Asbestos	Sample Type	% Asbestos	Sample #
Ceiling	Acoustical Tile, Lay In	M	N	200 SF	Non ASB	Sampled	0	R2154
Wall	Sheet Rock	M	N	480 SF	Non ASB	Sampled	0	R2123

Building No: 00C **Room T001** **Description Toilet** **Drawing No: 2**

Location	Homogeneous Material	Class	Friable	Material Size	Type of Asbestos	Sample Type	% Asbestos	Sample #
Ceiling	Sheet Rock	M	N	0 SF	Non ASB	Sampled	0	003H05
Wall	Sheet Rock	M	N	0 SF	Non ASB	Sampled	0	003H05

Building No: 00C **Room T002** **Description Toilet** **Drawing No: 2**

Location	Homogeneous Material	Class	Friable	Material Size	Type of Asbestos	Sample Type	% Asbestos	Sample #
Ceiling	Joint Tape Compound	M	N	0 SF	Non ASB	Sampled	0	003H09
Ceiling	Sheet Rock	M	N	0 SF	Non ASB	Sampled	0	003H05
Wall	Joint Tape Compound	M	N	0 SF	Non ASB	Sampled	0	006H09
Wall	Sheet Rock	M	N	0 SF	Non ASB	Sampled	0	003H05

Building No: 00C **Room X00L** **Description Library** **Drawing No: 2**

Location	Homogeneous Material	Class	Friable	Material Size	Type of Asbestos	Sample Type	% Asbestos	Sample #
Ceiling	Acoustical Tile, Lay In	M	N	0 SF	Non ASB	Sampled	0	006H01
Wall	Joint Tape Compound	M	N	0 SF	Non ASB	Sampled	0	006H09
Wall	Sheet Rock	M	N	0 SF	Non ASB	Sampled	0	003H05

SACRAMENTO CITY UNIFIED SCHOOL DISTRICT - AHERA 3 YEAR SUSPECT MATERIAL REPORT

DATE PRINTED: 7/1/2011 1

Page 10 of 19

SITE: 111		MARIAN ANDERSON				Address: 2850 49TH STREET, Sacramento 95819					
Building No:	00C	Room	ZEXT	Description	Exterior		Drawing No:	2			
Location	Homogeneous Material	Class	Friable	Material Size		Type of Asbestos	Sample Type	% Asbestos	Sample #		
Exterior, Wall	Plaster	S	N	2000	SF	Non ASB	Sampled	0	E3028		
Piping	Heat Hot Water Insulation	T	N	0	LF	Non ASB	Sampled	0	E3038		

SACRAMENTO CITY UNIFIED SCHOOL DISTRICT - AHERA 3 YEAR SUSPECT MATERIAL REPORT

DATE PRINTED: 7/1/2011 1

SITE: 111		MARIAN ANDERSON			Address: 2850 49TH STREET, Sacramento 95819				
Building No:	00D	Room	O00K	Description	Classroom		Drawing No:	2	
Location	Homogeneous Material	Class	Friable	Material Size	Type of Asbestos	Sample Type	% Asbestos	Sample #	
Ceiling	Acoustical Tile, Lay In	M	N	0 SF	Non ASB	Sampled	0	006H02	
Flooring	Tile 12 In.	M	N	600 SF	Serp	Sampled	1	E3026	
Wall	Joint Tape Compound	M	N	0 SF	Non ASB	Sampled	0	003H09	
Wall	Sheet Rock	M	N	0 SF	Non ASB	Sampled	0	003H05	

Building No:	00D	Room	O00L	Description	Classroom		Drawing No:	2	
Location	Homogeneous Material	Class	Friable	Material Size	Type of Asbestos	Sample Type	% Asbestos	Sample #	
Ceiling	Acoustical Tile, Lay In	M	N	0 SF	Non ASB	Sampled	0	006H02	
Wall	Joint Tape Compound	M	N	0 SF	Non ASB	Sampled	0	003H09	
Wall	Sheet Rock	M	N	0 SF	Non ASB	Sampled	0	003H05	

Building No:	00D	Room	O00M	Description	Classroom		Drawing No:	2	
Location	Homogeneous Material	Class	Friable	Material Size	Type of Asbestos	Sample Type	% Asbestos	Sample #	
Ceiling	Acoustical Tile, Lay In	M	N	0 SF	Non ASB	Sampled	0	006H02	
Flooring	Tile 12 In.	M	N	600 SF	Serp	Sampled	0	E3026	
Wall	Joint Tape Compound	M	N	0 SF	Non ASB	Sampled	0	003H09	
Wall	Sheet Rock	M	N	0 SF	Non ASB	Sampled	0	003H06	

Building No:	00D	Room	O00R	Description	Classroom		Drawing No:	2	
Location	Homogeneous Material	Class	Friable	Material Size	Type of Asbestos	Sample Type	% Asbestos	Sample #	
Ceiling	Acoustical Tile, Lay In	M	N	0 SF	Non ASB	Sampled	0	006H02	
Flooring	Tile 12 In.	M	N	960 SF	Serp	Sampled	0	E3026	
Wall	Sheet Rock	M	N	0 SF	Non ASB	Sampled	0	003H05	

Building No:	00D	Room	O00S	Description	Classroom		Drawing No:	2	
Location	Homogeneous Material	Class	Friable	Material Size	Type of Asbestos	Sample Type	% Asbestos	Sample #	
Ceiling	Acoustical Tile, Lay In	M	N	0 SF	Non ASB	Sampled	0	006H02	
Flooring	Tile 12 In.	M	N	960 SF	Serp	Sampled	0	E3026	
Wall	Joint Tape Compound	M	N	0 SF	Non ASB	Sampled	0	003H09	
Wall	Sheet Rock	M	N	0 SF	Non ASB	Sampled	0	003H05	

SACRAMENTO CITY UNIFIED SCHOOL DISTRICT - AHERA 3 YEAR SUSPECT MATERIAL REPORT

DATE PRINTED: 7/1/2011 1

Page 12 of 19

SITE: 111		MARIAN ANDERSON				Address: 2850 49TH STREET, Sacramento 95819			
Building No:	00D	Room	P001	Description	Plenum	Drawing No:	2A		
Location	Homogeneous Material	Class	Friable	Material Size	Type of Asbestos	Sample Type	% Asbestos	Sample #	
Attic	Attic Insulation	M	N	4500 SF	Non ASB	Sampled	0	B1721	

Building No:	00D	Room	S001	Description	Storage	Drawing No:	2		
Location	Homogeneous Material	Class	Friable	Material Size	Type of Asbestos	Sample Type	% Asbestos	Sample #	
Ceiling	Acoustical Tile, Lay In	M	N	88 SF	Non ASB	Sampled	0	R2157	
Wall	Sheet Rock	M	N	360 SF	Non ASB	Sampled	0	R2126	

Building No:	00D	Room	ZEXT	Description	Exterior	Drawing No:	2		
Location	Homogeneous Material	Class	Friable	Material Size	Type of Asbestos	Sample Type	% Asbestos	Sample #	
Exterior, Wall	Plaster	S	N	1200 SF	Non ASB	Sampled	0	E3028	

SACRAMENTO CITY UNIFIED SCHOOL DISTRICT - AHERA 3 YEAR SUSPECT MATERIAL REPORT

DATE PRINTED: 7/1/2011 1

SITE: 111		MARIAN ANDERSON			Address: 2850 49TH STREET, Sacramento 95819			
Building No:	00E	Room	C001	Description	Office	Drawing No:	2	
Location	Homogeneous Material	Class	Friable	Material Size	Type of Asbestos	Sample Type	% Asbestos	Sample #
Ceiling	Sheet Rock	M	N	0 SF	Non ASB	Sampled	0	003H07
Wall	Sheet Rock	M	N	0 SF	Non ASB	Sampled	0	003H06

Building No:	00E	Room	C002	Description	Office	Drawing No:	2	
Location	Homogeneous Material	Class	Friable	Material Size	Type of Asbestos	Sample Type	% Asbestos	Sample #
Ceiling	Sheet Rock	M	N	92 SF	Non ASB	Sampled	0	R2129
Wall	Fire Rated Door	M	N	21 SF	Other	Assumed	N/A	
Wall	Sheet Rock	M	N	292 SF	Non ASB	Sampled	0	R2126

Building No:	00E	Room	H001	Description	Hallway/Stairs	Drawing No:	2	
Location	Homogeneous Material	Class	Friable	Material Size	Type of Asbestos	Sample Type	% Asbestos	Sample #
Ceiling	Sheet Rock	M	N	0 SF	Non ASB	Sampled	0	003H07
Flooring	Tile 12 In.	M	N	650 SF	Non ASB	Sampled	0	J1209
Wall	Sheet Rock	M	N	1025 SF	Non ASB	Sampled	0	R2126

Building No:	00E	Room	I001	Description	Lounge	Drawing No:	2	
Location	Homogeneous Material	Class	Friable	Material Size	Type of Asbestos	Sample Type	% Asbestos	Sample #
Ceiling	Sheet Rock	M	N	112 SF	Non ASB	Sampled	0	R2129
Wall	Fire Rated Door	M	N	21 SF	Other	Assumed	N/A	
Wall	Sheet Rock	M	N	332 SF	Non ASB	Sampled	0	R2126

Building No:	00E	Room	O00N	Description	Classroom	Drawing No:	2	
Location	Homogeneous Material	Class	Friable	Material Size	Type of Asbestos	Sample Type	% Asbestos	Sample #
Ceiling	Acoustical Tile, Lay In	M	N	0 SF	Non ASB	Sampled	0	006H02
Flooring	Vinyl Sheet	M	N	SF	Non ASB	Sampled	0	J1208
Wall	Fire Rated Door	M	N	21 SF	Other	Assumed	N/A	
Wall	Joint Tape Compound	M	N	0 SF	Non ASB	Sampled	0	003H09
Wall	Sheet Rock	M	N	0 SF	Non ASB	Sampled	0	003H08

SACRAMENTO CITY UNIFIED SCHOOL DISTRICT - AHERA 3 YEAR SUSPECT MATERIAL REPORT

DATE PRINTED: 7/1/2011 1

Page 14 of 19

SITE: 111 MARIAN ANDERSON Address: 2850 49TH STREET, Sacramento 95819

Building No: 00E Room O000 Description Classroom Drawing No: 2

Location	Homogeneous Material	Class	Friable	Material Size	Type of Asbestos	Sample Type	% Asbestos	Sample #
Ceiling	Acoustical Tile, Lay In	M	N	0 SF	Non ASB	Sampled	0	006H02
Flooring	Vinyl Sheet	M	N	SF	Non ASB	Sampled	0	J1208
Wall	Fire Rated Door	M	N	21 SF	Other	Assumed	N/A	
Wall	Sheet Rock	M	N	0 SF	Non ASB	Sampled	0	003H08

Building No: 00E Room O00P Description Classroom Drawing No: 2

Location	Homogeneous Material	Class	Friable	Material Size	Type of Asbestos	Sample Type	% Asbestos	Sample #
Ceiling	Acoustical Tile, Lay In	M	N	0 SF	Non ASB	Sampled	0	006H02
Flooring	Vinyl Sheet	M	N	SF	Non ASB	Sampled	0	J1208
Wall	Fire Rated Door	M	N	21 SF	Other	Assumed	N/A	
Wall	Sheet Rock	M	N	0 SF	Non ASB	Sampled	0	003H07

Building No: 00E Room O00Q Description Classroom Drawing No: 2

Location	Homogeneous Material	Class	Friable	Material Size	Type of Asbestos	Sample Type	% Asbestos	Sample #
Ceiling	Acoustical Tile, Lay In	M	N	0 SF	Non ASB	Sampled	0	006H02
Flooring	Vinyl Sheet	M	N	SF	Non ASB	Sampled	0	J1208
Wall	Fire Rated Door	M	N	21 SF	Other	Assumed	N/A	
Wall	Joint Tape Compound	M	N	0 SF	Non ASB	Sampled	0	003H09
Wall	Sheet Rock	M	N	0 SF	Non ASB	Sampled	0	003H08

Building No: 00E Room P001 Description Plenum Drawing No: 2A

Location	Homogeneous Material	Class	Friable	Material Size	Type of Asbestos	Sample Type	% Asbestos	Sample #
Attic	Attic Insulation	M	N	500 SF	Non ASB	Sampled	0	B1741
Ceiling	Sheet Rock	M	N	1000 SF	Non ASB	Sampled	0	R2129
HVAC	Duct Seal	M	N	0 SF	Non ASB	Sampled	0	
Wall	Sheet Rock	M	N	1025 SF	Non ASB	Sampled	0	R2126

SACRAMENTO CITY UNIFIED SCHOOL DISTRICT - AHERA 3 YEAR SUSPECT MATERIAL REPORT

DATE PRINTED: 7/1/2011 1

SITE: 111 MARIAN ANDERSON Address: 2850 49TH STREET, Sacramento 95819

Building No: 00E Room S001 Description Storage Drawing No: 2

Location	Homogeneous Material	Class	Friable	Material Size	Type of Asbestos	Sample Type	% Asbestos	Sample #
Ceiling	Joint Tape Compound	M	N	0 SF	Non ASB	Sampled	0	003H09
Ceiling	Sheet Rock	M	N	0 SF	Non ASB	Sampled	0	003H07
Wall	Fire Rated Door	M	N	21 SF	Other	Assumed	N/A	
Wall	Joint Tape Compound	M	N	0 SF	Non ASB	Sampled	0	003H09
Wall	Sheet Rock	M	N	0 SF	Non ASB	Sampled	0	003H06

Building No: 00E Room S00N Description Storage Drawing No: 2

Location	Homogeneous Material	Class	Friable	Material Size	Type of Asbestos	Sample Type	% Asbestos	Sample #
Ceiling	Joint Tape Compound	M	N	0 SF	Non ASB	Sampled	0	003H09
Ceiling	Sheet Rock	M	N	0 SF	Non ASB	Sampled	0	003H07
Flooring	Vinyl Sheet	M	N	SF	Non ASB	Sampled	0	J1208
Wall	Fire Rated Door	M	N	21 SF	Other	Assumed	N/A	
Wall	Joint Tape Compound	M	N	0 SF	Non ASB	Sampled	0	003H09
Wall	Sheet Rock	M	N	0 SF	Non ASB	Sampled	0	003H07

Building No: 00E Room S00P Description Storage Drawing No: 2

Location	Homogeneous Material	Class	Friable	Material Size	Type of Asbestos	Sample Type	% Asbestos	Sample #
Ceiling	Sheet Rock	M	N	0 SF	Non ASB	Sampled	0	003H07
Flooring	Vinyl Sheet	M	N	SF	Non ASB	Sampled	0	J1208
Wall	Sheet Rock	M	N	0 SF	Non ASB	Sampled	0	003H08

Building No: 00E Room T000 Description Toilet Drawing No: 2

Location	Homogeneous Material	Class	Friable	Material Size	Type of Asbestos	Sample Type	% Asbestos	Sample #
Ceiling	Sheet Rock	M	N	42 SF	Non ASB	Sampled	0	R2129
Wall	Sheet Rock	M	N	162 SF	Non ASB	Sampled	0	R2126

SACRAMENTO CITY UNIFIED SCHOOL DISTRICT - AHERA 3 YEAR SUSPECT MATERIAL REPORT

DATE PRINTED: 7/1/2011 1

SITE: 111 **MARIAN ANDERSON** **Address: 2850 49TH STREET, Sacramento 95819**

Building No: 00E **Room** **T001** **Description** **Toilet** **Drawing No: 2**

Location	Homogeneous Material	Class	Friable	Material Size	Type of Asbestos	Sample Type	% Asbestos	Sample #
Ceiling	Sheet Rock	M	N	0 SF	Non ASB	Sampled	0	003H07
Flooring	Vinyl Sheet	M	N	88 SF	Serp	Sampled	20	B3359
Wall	Fire Rated Door	M	N	21 SF	Other	Assumed	N/A	
Wall	Sheet Rock	M	N	0 SF	Non ASB	Sampled	0	003H07

Building No: 00E **Room** **T002** **Description** **Toilet** **Drawing No: 2**

Location	Homogeneous Material	Class	Friable	Material Size	Type of Asbestos	Sample Type	% Asbestos	Sample #
Ceiling	Joint Tape Compound	M	N	0 SF	Non ASB	Sampled	0	003H09
Ceiling	Sheet Rock	M	N	0 SF	Non ASB	Sampled	0	003H07
Wall	Joint Tape Compound	M	N	0 SF	Non ASB	Sampled	0	003H09
Wall	Sheet Rock	M	N	0 SF	Non ASB	Sampled	0	003H07

Building No: 00E **Room** **T00N** **Description** **Toilet** **Drawing No: 2**

Location	Homogeneous Material	Class	Friable	Material Size	Type of Asbestos	Sample Type	% Asbestos	Sample #
Ceiling	Sheet Rock	M	N	0 SF	Non ASB	Sampled	0	003H07
Wall	Sheet Rock	M	N	0 SF	Non ASB	Sampled	0	003H07

Building No: 00E **Room** **T00P** **Description** **Toilet** **Drawing No: 2**

Location	Homogeneous Material	Class	Friable	Material Size	Type of Asbestos	Sample Type	% Asbestos	Sample #
Ceiling	Sheet Rock	M	N	0 SF	Non ASB	Sampled	0	003H07
Wall	Sheet Rock	M	N	0 SF	Non ASB	Sampled	0	003H06

Building No: 00E **Room** **T00Q** **Description** **Toilet** **Drawing No: 2**

Location	Homogeneous Material	Class	Friable	Material Size	Type of Asbestos	Sample Type	% Asbestos	Sample #
Ceiling	Sheet Rock	M	N	0 SF	Non ASB	Sampled	0	003H07
Wall	Fire Rated Door	M	N	21 SF	Other	Assumed	N/A	
Wall	Sheet Rock	M	N	0 SF	Non ASB	Sampled	0	003H06

SACRAMENTO CITY UNIFIED SCHOOL DISTRICT - AHERA 3 YEAR SUSPECT MATERIAL REPORT

DATE PRINTED: 7/1/2011 1

Page 17 of 19

SITE: 111 **MARIAN ANDERSON** **Address: 2850 49TH STREET, Sacramento 95819**

Building No: 00E **Room T021** **Description Toilet** **Drawing No: 2**

Location	Homogeneous Material	Class	Friable	Material Size	Type of Asbestos	Sample Type	% Asbestos	Sample #
Ceiling	Sheet Rock	M	N	0 SF	Non ASB	Sampled	0	003H07
Flooring	Vinyl Sheet	M	N	40 SF	Serp	Sampled	20	B3330 Under non-asbestos flooring
Wall	Sheet Rock	M	N	0 SF	Non ASB	Sampled	0	003H08

Building No: 00E **Room Z001** **Description Misc. Room** **Drawing No: 2**

Location	Homogeneous Material	Class	Friable	Material Size	Type of Asbestos	Sample Type	% Asbestos	Sample #
Ceiling	Joint Tape Compound	M	N	0 SF	Non ASB	Sampled	0	003H09
Ceiling	Sheet Rock	M	N	0 SF	Non ASB	Sampled	0	003H07
Wall	Fire Rated Door	M	N	21 SF	Other	Assumed	N/A	
Wall	Joint Tape Compound	M	N	0 SF	Non ASB	Sampled	0	003H09
Wall	Sheet Rock	M	N	0 SF	Non ASB	Sampled	0	003H00

Building No: 00E **Room ZEXT** **Description Exterior** **Drawing No: 2**

Location	Homogeneous Material	Class	Friable	Material Size	Type of Asbestos	Sample Type	% Asbestos	Sample #
Exterior, Wall	Plaster	S	N	2000 SF	Non ASB	Sampled	0	E3029

SACRAMENTO CITY UNIFIED SCHOOL DISTRICT - AHERA 3 YEAR SUSPECT MATERIAL REPORT

DATE PRINTED: 7/1/2011 1

SITE: 111		MARIAN ANDERSON			Address: 2850 49TH STREET, Sacramento 95819				
Building No:	P01	Room	O005	Description	Classroom		Drawing No:	3	Built With Non-Asbestos Materials
Location	Homogeneous Material	Class	Friable	Material Size	Type of Asbestos	Sample Type	% Asbestos	Sample #	

Building No:	P01	Room	O006	Description	Classroom		Drawing No:	3	Built With Non-Asbestos Materials
Location	Homogeneous Material	Class	Friable	Material Size	Type of Asbestos	Sample Type	% Asbestos	Sample #	

Building No:	P01	Room	O007	Description	Classroom		Drawing No:	3	Built With Non-Asbestos Materials
Location	Homogeneous Material	Class	Friable	Material Size	Type of Asbestos	Sample Type	% Asbestos	Sample #	

Building No:	P01	Room	O008	Description	Classroom		Drawing No:	3	Built With Non-Asbestos Materials
Location	Homogeneous Material	Class	Friable	Material Size	Type of Asbestos	Sample Type	% Asbestos	Sample #	

Building No:	P01	Room	O009	Description	Classroom		Drawing No:	3	Built With Non-Asbestos Materials
Location	Homogeneous Material	Class	Friable	Material Size	Type of Asbestos	Sample Type	% Asbestos	Sample #	

Building No:	P01	Room	O010	Description	Classroom		Drawing No:	3	Built With Non-Asbestos Materials
Location	Homogeneous Material	Class	Friable	Material Size	Type of Asbestos	Sample Type	% Asbestos	Sample #	

SACRAMENTO CITY UNIFIED SCHOOL DISTRICT - AHERA 3 YEAR SUSPECT MATERIAL REPORT

DATE PRINTED: 7/1/2011 1

SITE: 111		MARIAN ANDERSON			Address: 2850 49TH STREET, Sacramento 95819			
Building No:	P03	Room	O0B7	Description	Classroom	Drawing No:	3	Built With Non-Asbestos Materials
Location	Homogeneous Material	Class	Friable	Material Size	Type of Asbestos	Sample Type	% Asbestos	Sample #

Building No:	P03	Room	O0B8	Description	Classroom	Drawing No:	3	Built With Non-Asbestos Materials
Location	Homogeneous Material	Class	Friable	Material Size	Type of Asbestos	Sample Type	% Asbestos	Sample #

Building No:	P03	Room	O0B9	Description	Classroom	Drawing No:	3	Built With Non-Asbestos Materials
Location	Homogeneous Material	Class	Friable	Material Size	Type of Asbestos	Sample Type	% Asbestos	Sample #

Building No:	P03	Room	OB10	Description	Classroom	Drawing No:	3	Built With Non-Asbestos Materials
Location	Homogeneous Material	Class	Friable	Material Size	Type of Asbestos	Sample Type	% Asbestos	Sample #