

Genevieve Didion K-8 School (350)  
 6490 Harmon Drive  
 SACRAMENTO CITY UNIFIED SCHOOL DISTRICT

# AHERA Management Plan

BLD 001

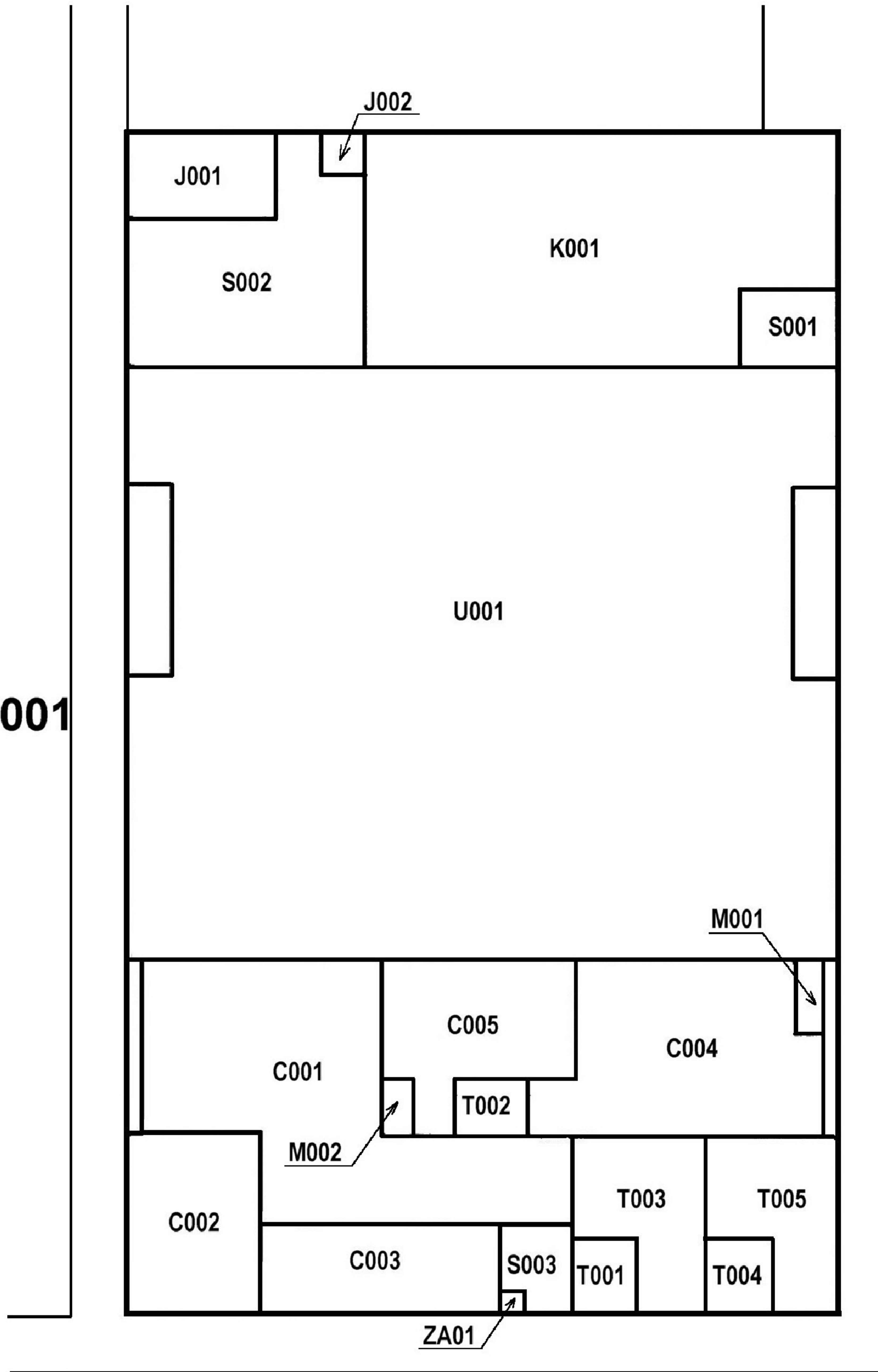

GENEVIEVE DIDION

DRAWING No.	1
SPACE	
FLOOR	1ST

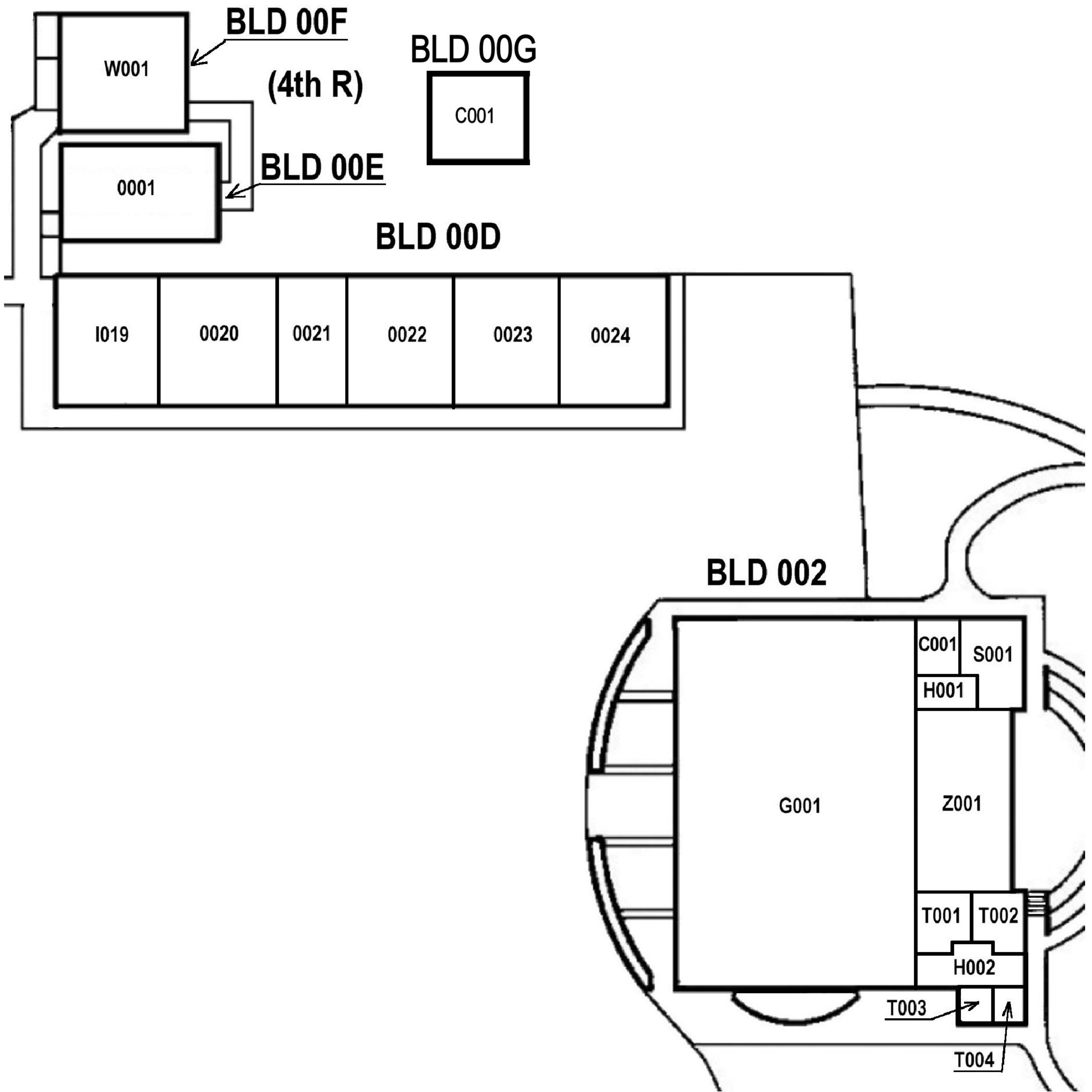

GENEVIEVE DIDION

DRAWING No.	2
SPACE	
FLOOR	1ST

**BLD 00A**

**BLD 00B**

**BLD 00C**

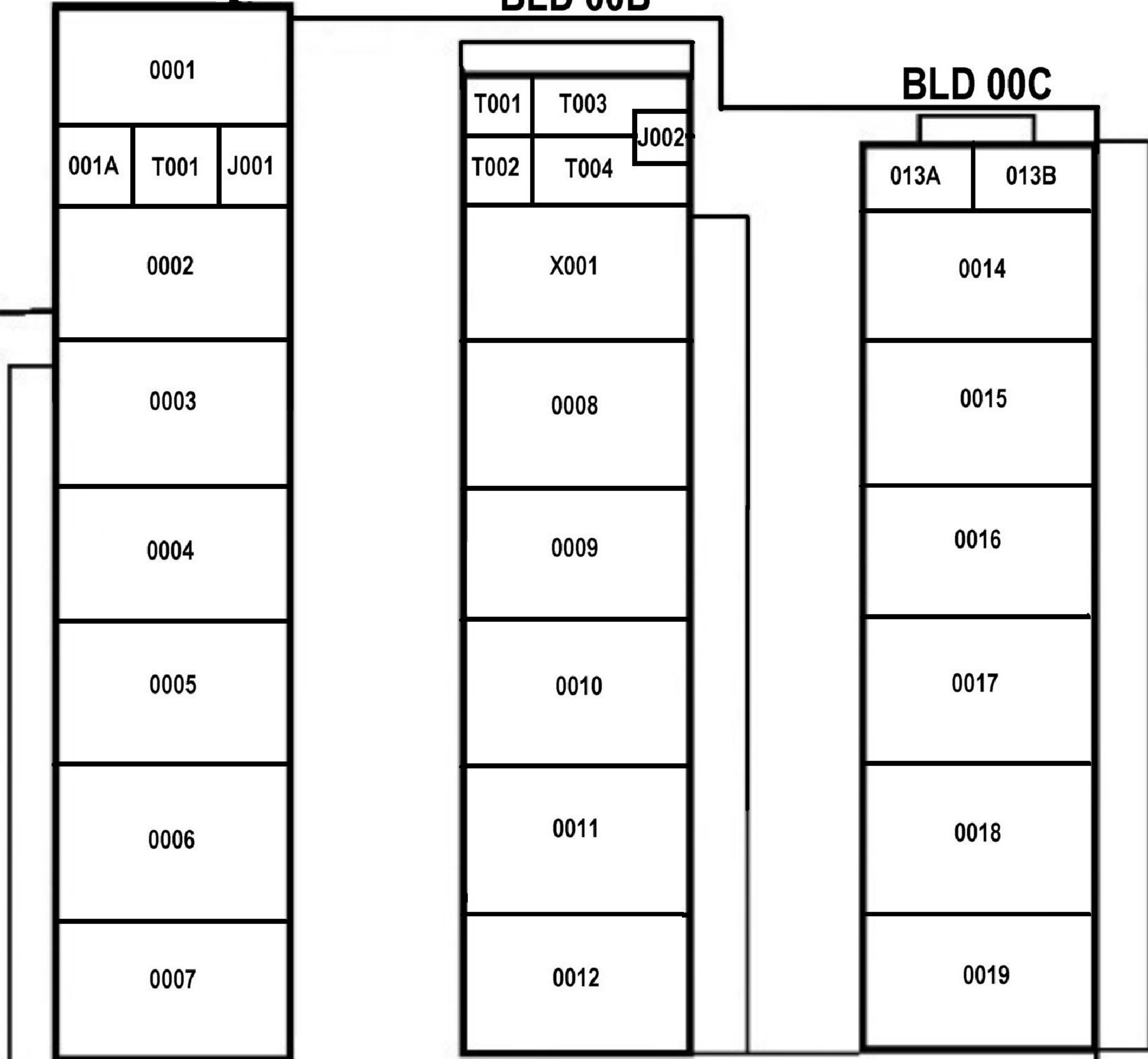

NORTH

**GENEVIEVE DIDION**

DRAWING No.	3
SPACE	
FLOOR	1ST

**SACRAMENTO CITY UNIFIED SCHOOL DISTRICT - AHERA 3 YEAR SUSPECT MATERIAL REPORT**

**DATE PRINTED: 7/1/2011 1**

<b>SITE: 350</b>		<b>GENEVIEVE DIDION</b>				<b>Address: 6490 HARMON DRIVE, Sacramento 95831</b>				
<b>Building No:</b>	<b>001</b>	<b>Room</b>	<b>C001</b>	<b>Description</b>	<b>Office</b>		<b>Drawing No:</b>	<b>1</b>		
<b>Location</b>	<b>Homogeneous Material</b>	<b>Class</b>	<b>Friable</b>	<b>Material Size</b>		<b>Type of Asbestos</b>	<b>Sample Type</b>	<b>% Asbestos</b>	<b>Sample #</b>	
Ceiling	Acoustical Tile, Splined	M	N	126	SF	Non ASB	Sampled	0	T1014	
Ceiling	Sheet Rock	M	N	0	SF	Non ASB	Sampled	0	013H01	
Flooring	Tile 12 In.	M	N	356	SF	Serp	Sampled	2	B1204	
Wall	Sheet Rock	M	N	700	SF	Non ASB	Sampled	0	R2270	

<b>Building No:</b>	<b>001</b>	<b>Room</b>	<b>C002</b>	<b>Description</b>	<b>Office</b>		<b>Drawing No:</b>	<b>1</b>		
<b>Location</b>	<b>Homogeneous Material</b>	<b>Class</b>	<b>Friable</b>	<b>Material Size</b>		<b>Type of Asbestos</b>	<b>Sample Type</b>	<b>% Asbestos</b>	<b>Sample #</b>	
Ceiling	Acoustical Tile, Splined	M	N	56	SF	Non ASB	Sampled	0	T1014	
Ceiling	Sheet Rock	M	N	0	SF	Non ASB	Sampled	0	013H01	
Wall	Sheet Rock	M	N	0	SF	Non ASB	Sampled	0	013H01	

<b>Building No:</b>	<b>001</b>	<b>Room</b>	<b>C003</b>	<b>Description</b>	<b>Office</b>		<b>Drawing No:</b>	<b>1</b>		
<b>Location</b>	<b>Homogeneous Material</b>	<b>Class</b>	<b>Friable</b>	<b>Material Size</b>		<b>Type of Asbestos</b>	<b>Sample Type</b>	<b>% Asbestos</b>	<b>Sample #</b>	
Ceiling	Acoustical Tile, Splined	M	N	108	SF	Non ASB	Sampled	0	T1014	
Ceiling	Sheet Rock	M	N	0	SF	Non ASB	Sampled	0	013H01	
Wall	Sheet Rock	M	N	0	SF	Non ASB	Sampled	0	013H01	

<b>Building No:</b>	<b>001</b>	<b>Room</b>	<b>C004</b>	<b>Description</b>	<b>Office</b>		<b>Drawing No:</b>	<b>1</b>		
<b>Location</b>	<b>Homogeneous Material</b>	<b>Class</b>	<b>Friable</b>	<b>Material Size</b>		<b>Type of Asbestos</b>	<b>Sample Type</b>	<b>% Asbestos</b>	<b>Sample #</b>	
Ceiling	Sheet Rock	M	N	0	SF	Non ASB	Sampled	0	013H02	
Flooring	Tile 12 In.	M	N	322	SF	Serp	Sampled	2	B1204	
Wall	Sheet Rock	M	N	0	SF	Non ASB	Sampled	0	013H01	

<b>Building No:</b>	<b>001</b>	<b>Room</b>	<b>C005</b>	<b>Description</b>	<b>Office</b>		<b>Drawing No:</b>	<b>1</b>		
<b>Location</b>	<b>Homogeneous Material</b>	<b>Class</b>	<b>Friable</b>	<b>Material Size</b>		<b>Type of Asbestos</b>	<b>Sample Type</b>	<b>% Asbestos</b>	<b>Sample #</b>	
Ceiling	Acoustical Tile, Splined	M	N	55	SF	Non ASB	Sampled	0	T1014	
Ceiling	Sheet Rock	M	N	0	SF	Non ASB	Sampled	0	013H02	
Flooring	Tile 12 In.	M	N	48	SF	Serp	Sampled	2	B1204	
Wall	Sheet Rock	M	N	0	SF	Non ASB	Sampled	0	013H02	

**SACRAMENTO CITY UNIFIED SCHOOL DISTRICT - AHERA 3 YEAR SUSPECT MATERIAL REPORT**

DATE PRINTED: 7/1/2011 1

Page 2 of 13

SITE: 350 GENEVIEVE DIDION Address: 6490 HARMON DRIVE, Sacramento 95831

Building No: 001 Room J001 Description Custodial Closet Drawing No: 1

Location	Homogeneous Material	Class	Friable	Material Size	Type of Asbestos	Sample Type	% Asbestos	Sample #
Ceiling	Sheet Rock	M	N	0 SF	Non ASB	Sampled	0	013H00
Flooring	Tile 12 In.	M	N	72 SF	Serp	Sampled	2	B1204
Wall	Sheet Rock	M	N	0 SF	Non ASB	Sampled	0	013H00

Building No: 001 Room J002 Description Custodial Closet Drawing No: 1

Location	Homogeneous Material	Class	Friable	Material Size	Type of Asbestos	Sample Type	% Asbestos	Sample #
Ceiling	Sheet Rock	M	N	0 SF	Non ASB	Sampled	0	013H00
Wall	Sheet Rock	M	N	0 SF	Non ASB	Sampled	0	013H00

Building No: 001 Room K001 Description Kitchen Drawing No: 1

Location	Homogeneous Material	Class	Friable	Material Size	Type of Asbestos	Sample Type	% Asbestos	Sample #
Ceiling	Acoustical Tile, Lay In	M	N	0 SF	Non ASB	Sampled	0	002B00
Flooring	Tile 12 In.	M	N	722 SF	Serp	Sampled	2	B1204
Wall	Fire Rated Door	M	N	21 SF	Other	Assumed	N/A	
Wall	Sheet Rock	M	N	0 SF	Non ASB	Sampled	0	013H00

Building No: 001 Room M001 Description Mechanical Room Drawing No: 1

Location	Homogeneous Material	Class	Friable	Material Size	Type of Asbestos	Sample Type	% Asbestos	Sample #
Ceiling	Sheet Rock	M	N	12 SF	Non ASB	Sampled	0	R2282
HVAC	Duct Seal	M	N	0 SF	Non ASB	Sampled	0	003B00
HVAC	Flex Joint	M	N	6 SF	Other	Assumed	N/A	
Wall	Sheet Rock	M	N	0 SF	Non ASB	Sampled	0	013H01

Building No: 001 Room M002 Description Mechanical Room Drawing No: 1

Location	Homogeneous Material	Class	Friable	Material Size	Type of Asbestos	Sample Type	% Asbestos	Sample #
Ceiling	Sheet Rock	M	N	12 SF	Non ASB	Sampled	0	013H02
Flooring	Tile 12 In.	M	N	12 SF	Serp	Sampled	2	R2279
Wall	Sheet Rock	M	N	45 SF	Non ASB	Sampled	0	013H02

**SACRAMENTO CITY UNIFIED SCHOOL DISTRICT - AHERA 3 YEAR SUSPECT MATERIAL REPORT**

DATE PRINTED: 7/1/2011 1

SITE: 350 GENEVIEVE DIDION Address: 6490 HARMON DRIVE, Sacramento 95831

Building No: 001 Room S001 Description Storage Drawing No: 1

Location	Homogeneous Material	Class	Friable	Material Size	Type of Asbestos	Sample Type	% Asbestos	Sample #
Ceiling	Sheet Rock	M	N	0 SF	Non ASB	Sampled	0	013H00
Flooring	Tile 12 In.	M	N	64 SF	Serp	Sampled	2	B1204
Wall	Sheet Rock	M	N	0 SF	Non ASB	Sampled	0	013H00

Building No: 001 Room S002 Description Storage Drawing No: 1

Location	Homogeneous Material	Class	Friable	Material Size	Type of Asbestos	Sample Type	% Asbestos	Sample #
Ceiling	Sheet Rock	M	N	0 SF	Non ASB	Sampled	0	013H00
Flooring	Tile 12 In.	M	N	266 SF	Serp	Sampled	2	B1204
Wall	Fire Rated Door	M	N	0 SF	Other	Assumed	N/A	
Wall	Sheet Rock	M	N	0 SF	Non ASB	Sampled	0	013H00

Building No: 001 Room S003 Description Storage Drawing No: 1

Location	Homogeneous Material	Class	Friable	Material Size	Type of Asbestos	Sample Type	% Asbestos	Sample #
Ceiling	Sheet Rock	M	N	0 SF	Non ASB	Sampled	0	013H02
Flooring	Tile 12 In.	M	N	64 SF	Serp	Sampled	2	B1204
Wall	Sheet Rock	M	N	0 SF	Non ASB	Sampled	0	013H02

Building No: 001 Room T001 Description Toilet Drawing No: 1

Location	Homogeneous Material	Class	Friable	Material Size	Type of Asbestos	Sample Type	% Asbestos	Sample #
Ceiling	Sheet Rock	M	N	0 SF	Non ASB	Sampled	0	013H01
Wall	Sheet Rock	M	N	0 SF	Non ASB	Sampled	0	013H01

Building No: 001 Room T002 Description Toilet Drawing No: 1

Location	Homogeneous Material	Class	Friable	Material Size	Type of Asbestos	Sample Type	% Asbestos	Sample #
Ceiling	Sheet Rock	M	N	0 SF	Non ASB	Sampled	0	013H02
Flooring	Vinyl Sheet	M	N	SF	Serp	Sampled	20	B3470
Wall	Sheet Rock	M	N	0 SF	Non ASB	Sampled	0	013H02

**SACRAMENTO CITY UNIFIED SCHOOL DISTRICT - AHERA 3 YEAR SUSPECT MATERIAL REPORT**

DATE PRINTED: 7/1/2011 1

Page 4 of 13

SITE: 350 GENEVIEVE DIDION Address: 6490 HARMON DRIVE, Sacramento 95831

Building No: 001 Room T003 Description Toilet Drawing No: 1

Location	Homogeneous Material	Class	Friable	Material Size	Type of Asbestos	Sample Type	% Asbestos	Sample #
Ceiling	Sheet Rock	M	N	200 SF	Non ASB	Sampled	0	R2282
Wall	Sheet Rock	M	N	400 SF	Non ASB	Sampled	0	R2282

Building No: 001 Room T004 Description Toilet Drawing No: 1

Location	Homogeneous Material	Class	Friable	Material Size	Type of Asbestos	Sample Type	% Asbestos	Sample #
Ceiling	Sheet Rock	M	N	35 SF	Non ASB	Sampled	0	R2282
Wall	Sheet Rock	M	N	200 SF	Non ASB	Sampled	0	R2270

Building No: 001 Room T005 Description Toilet Drawing No: 1

Location	Homogeneous Material	Class	Friable	Material Size	Type of Asbestos	Sample Type	% Asbestos	Sample #
Ceiling	Sheet Rock	M	N	200 SF	Non ASB	Sampled	0	R2282
Wall	Sheet Rock	M	N	400 SF	Non ASB	Sampled	0	R2270

Building No: 001 Room U001 Description Multipurpose/Cafeteria Drawing No: 1

Location	Homogeneous Material	Class	Friable	Material Size	Type of Asbestos	Sample Type	% Asbestos	Sample #
Ceiling	Acoustical Tile, Lay In	M	N	0 SF	Non ASB	Sampled	0	002B00
Ceiling	Sheet Rock	M	N	0 SF	Non ASB	Sampled	0	013H01
Flooring	Tile 12 In.	M	N	2773 SF	Serp	Sampled	1	B1207
Wall	Fire Rated Door	M	N	21 SF	Other	Assumed	N/A	
Wall	Sheet Rock	M	N	0 SF	Non ASB	Sampled	0	013H00

Building No: 001 Room ZA01 Description Attic Drawing No: 1

No Suspect Materials Present

Location	Homogeneous Material	Class	Friable	Material Size	Type of Asbestos	Sample Type	% Asbestos	Sample #
----------	----------------------	-------	---------	---------------	------------------	-------------	------------	----------



**SACRAMENTO CITY UNIFIED SCHOOL DISTRICT - AHERA 3 YEAR SUSPECT MATERIAL REPORT**

**DATE PRINTED: 7/1/2011 1**

<b>SITE: 350</b>	<b>GENEVIEVE DIDION</b>				<b>Address: 6490 HARMON DRIVE, Sacramento 95831</b>			
<b>Building No:</b> 002	<b>Room</b> C001	<b>Description</b>	<b>Office</b>		<b>Drawing No:</b> 2	<b>Built With Non-Asbestos Materials</b>		
<b>Location</b>	<b>Homogeneous Material</b>	<b>Class</b>	<b>Friable</b>	<b>Material Size</b>	<b>Type of Asbestos</b>	<b>Sample Type</b>	<b>% Asbestos</b>	<b>Sample #</b>

<b>Building No:</b> 002	<b>Room</b> G001	<b>Description</b>	<b>Gym</b>		<b>Drawing No:</b> 2	<b>Built With Non-Asbestos Materials</b>		
<b>Location</b>	<b>Homogeneous Material</b>	<b>Class</b>	<b>Friable</b>	<b>Material Size</b>	<b>Type of Asbestos</b>	<b>Sample Type</b>	<b>% Asbestos</b>	<b>Sample #</b>

<b>Building No:</b> 002	<b>Room</b> H001	<b>Description</b>	<b>Hallway/Stairs</b>		<b>Drawing No:</b> 2	<b>Built With Non-Asbestos Materials</b>		
<b>Location</b>	<b>Homogeneous Material</b>	<b>Class</b>	<b>Friable</b>	<b>Material Size</b>	<b>Type of Asbestos</b>	<b>Sample Type</b>	<b>% Asbestos</b>	<b>Sample #</b>

<b>Building No:</b> 002	<b>Room</b> H002	<b>Description</b>	<b>Hallway/Stairs</b>		<b>Drawing No:</b> 2	<b>Built With Non-Asbestos Materials</b>		
<b>Location</b>	<b>Homogeneous Material</b>	<b>Class</b>	<b>Friable</b>	<b>Material Size</b>	<b>Type of Asbestos</b>	<b>Sample Type</b>	<b>% Asbestos</b>	<b>Sample #</b>

<b>Building No:</b> 002	<b>Room</b> S001	<b>Description</b>	<b>Storage</b>		<b>Drawing No:</b> 2	<b>Built With Non-Asbestos Materials</b>		
<b>Location</b>	<b>Homogeneous Material</b>	<b>Class</b>	<b>Friable</b>	<b>Material Size</b>	<b>Type of Asbestos</b>	<b>Sample Type</b>	<b>% Asbestos</b>	<b>Sample #</b>

<b>Building No:</b> 002	<b>Room</b> T001	<b>Description</b>	<b>Toilet</b>		<b>Drawing No:</b> 2	<b>Built With Non-Asbestos Materials</b>		
<b>Location</b>	<b>Homogeneous Material</b>	<b>Class</b>	<b>Friable</b>	<b>Material Size</b>	<b>Type of Asbestos</b>	<b>Sample Type</b>	<b>% Asbestos</b>	<b>Sample #</b>

<b>Building No:</b> 002	<b>Room</b> T002	<b>Description</b>	<b>Toilet</b>		<b>Drawing No:</b> 2	<b>Built With Non-Asbestos Materials</b>		
<b>Location</b>	<b>Homogeneous Material</b>	<b>Class</b>	<b>Friable</b>	<b>Material Size</b>	<b>Type of Asbestos</b>	<b>Sample Type</b>	<b>% Asbestos</b>	<b>Sample #</b>

**SACRAMENTO CITY UNIFIED SCHOOL DISTRICT - AHERA 3 YEAR SUSPECT MATERIAL REPORT**

**DATE PRINTED: 7/1/2011 1**

**Page 6 of 13**

<b>SITE: 350</b>		<b>GENEVIEVE DIDION</b>			<b>Address: 6490 HARMON DRIVE, Sacramento 95831</b>				
<b>Building No:</b>	<b>002</b>	<b>Room</b>	<b>T003</b>	<b>Description</b>	<b>Toilet</b>		<b>Drawing No:</b>	<b>2</b>	<b>Built With Non-Asbestos Materials</b>
<b>Location</b>	<b>Homogeneous Material</b>	<b>Class</b>	<b>Friable</b>	<b>Material Size</b>	<b>Type of Asbestos</b>	<b>Sample Type</b>	<b>% Asbestos</b>	<b>Sample #</b>	

<b>Building No:</b>	<b>002</b>	<b>Room</b>	<b>T004</b>	<b>Description</b>	<b>Toilet</b>		<b>Drawing No:</b>	<b>2</b>	<b>Built With Non-Asbestos Materials</b>
<b>Location</b>	<b>Homogeneous Material</b>	<b>Class</b>	<b>Friable</b>	<b>Material Size</b>	<b>Type of Asbestos</b>	<b>Sample Type</b>	<b>% Asbestos</b>	<b>Sample #</b>	

<b>Building No:</b>	<b>002</b>	<b>Room</b>	<b>Z001</b>	<b>Description</b>	<b>Stage</b>		<b>Drawing No:</b>	<b>2</b>	<b>Built With Non-Asbestos Materials</b>
<b>Location</b>	<b>Homogeneous Material</b>	<b>Class</b>	<b>Friable</b>	<b>Material Size</b>	<b>Type of Asbestos</b>	<b>Sample Type</b>	<b>% Asbestos</b>	<b>Sample #</b>	

**SACRAMENTO CITY UNIFIED SCHOOL DISTRICT - AHERA 3 YEAR SUSPECT MATERIAL REPORT**

**DATE PRINTED: 7/1/2011 1**

<b>SITE: 350</b>	<b>GENEVIEVE DIDION</b>				<b>Address: 6490 HARMON DRIVE, Sacramento 95831</b>			
<b>Building No:</b> 00A	<b>Room</b> J001	<b>Description</b>	Custodial Closet		<b>Drawing No:</b> 3	<b>Built With Non-Asbestos Materials</b>		
<b>Location</b>	<b>Homogeneous Material</b>	<b>Class</b>	<b>Friable</b>	<b>Material Size</b>	<b>Type of Asbestos</b>	<b>Sample Type</b>	<b>% Asbestos</b>	<b>Sample #</b>

<b>Building No:</b> 00A	<b>Room</b> O001	<b>Description</b>	Classroom		<b>Drawing No:</b> 3	<b>Built With Non-Asbestos Materials</b>		
<b>Location</b>	<b>Homogeneous Material</b>	<b>Class</b>	<b>Friable</b>	<b>Material Size</b>	<b>Type of Asbestos</b>	<b>Sample Type</b>	<b>% Asbestos</b>	<b>Sample #</b>

<b>Building No:</b> 00A	<b>Room</b> O002	<b>Description</b>	Classroom		<b>Drawing No:</b> 3	<b>Built With Non-Asbestos Materials</b>		
<b>Location</b>	<b>Homogeneous Material</b>	<b>Class</b>	<b>Friable</b>	<b>Material Size</b>	<b>Type of Asbestos</b>	<b>Sample Type</b>	<b>% Asbestos</b>	<b>Sample #</b>

<b>Building No:</b> 00A	<b>Room</b> O003	<b>Description</b>	Classroom		<b>Drawing No:</b> 3	<b>Built With Non-Asbestos Materials</b>		
<b>Location</b>	<b>Homogeneous Material</b>	<b>Class</b>	<b>Friable</b>	<b>Material Size</b>	<b>Type of Asbestos</b>	<b>Sample Type</b>	<b>% Asbestos</b>	<b>Sample #</b>

<b>Building No:</b> 00A	<b>Room</b> O004	<b>Description</b>	Classroom		<b>Drawing No:</b> 3	<b>Built With Non-Asbestos Materials</b>		
<b>Location</b>	<b>Homogeneous Material</b>	<b>Class</b>	<b>Friable</b>	<b>Material Size</b>	<b>Type of Asbestos</b>	<b>Sample Type</b>	<b>% Asbestos</b>	<b>Sample #</b>

<b>Building No:</b> 00A	<b>Room</b> O005	<b>Description</b>	Classroom		<b>Drawing No:</b> 3	<b>Built With Non-Asbestos Materials</b>		
<b>Location</b>	<b>Homogeneous Material</b>	<b>Class</b>	<b>Friable</b>	<b>Material Size</b>	<b>Type of Asbestos</b>	<b>Sample Type</b>	<b>% Asbestos</b>	<b>Sample #</b>

<b>Building No:</b> 00A	<b>Room</b> O006	<b>Description</b>	Classroom		<b>Drawing No:</b> 3	<b>Built With Non-Asbestos Materials</b>		
<b>Location</b>	<b>Homogeneous Material</b>	<b>Class</b>	<b>Friable</b>	<b>Material Size</b>	<b>Type of Asbestos</b>	<b>Sample Type</b>	<b>% Asbestos</b>	<b>Sample #</b>

**SACRAMENTO CITY UNIFIED SCHOOL DISTRICT - AHERA 3 YEAR SUSPECT MATERIAL REPORT**

**DATE PRINTED: 7/1/2011 1**

**Page 8 of 13**

<b>SITE: 350</b>		<b>GENEVIEVE DIDION</b>			<b>Address: 6490 HARMON DRIVE, Sacramento 95831</b>			
<b>Building No:</b>	<b>00A</b>	<b>Room</b>	<b>O007</b>	<b>Description</b>	<b>Classroom</b>	<b>Drawing No:</b>	<b>3</b>	<b>Built With Non-Asbestos Materials</b>
<b>Location</b>	<b>Homogeneous Material</b>	<b>Class</b>	<b>Friable</b>	<b>Material Size</b>	<b>Type of Asbestos</b>	<b>Sample Type</b>	<b>% Asbestos</b>	<b>Sample #</b>

<b>Building No:</b>	<b>00A</b>	<b>Room</b>	<b>O01A</b>	<b>Description</b>	<b>Classroom</b>	<b>Drawing No:</b>	<b>3</b>	<b>Built With Non-Asbestos Materials</b>
<b>Location</b>	<b>Homogeneous Material</b>	<b>Class</b>	<b>Friable</b>	<b>Material Size</b>	<b>Type of Asbestos</b>	<b>Sample Type</b>	<b>% Asbestos</b>	<b>Sample #</b>

<b>Building No:</b>	<b>00A</b>	<b>Room</b>	<b>T001</b>	<b>Description</b>	<b>Toilet</b>	<b>Drawing No:</b>	<b>3</b>	<b>Built With Non-Asbestos Materials</b>
<b>Location</b>	<b>Homogeneous Material</b>	<b>Class</b>	<b>Friable</b>	<b>Material Size</b>	<b>Type of Asbestos</b>	<b>Sample Type</b>	<b>% Asbestos</b>	<b>Sample #</b>

**SACRAMENTO CITY UNIFIED SCHOOL DISTRICT - AHERA 3 YEAR SUSPECT MATERIAL REPORT**

**DATE PRINTED: 7/1/2011 1**

<b>SITE: 350</b>	<b>GENEVIEVE DIDION</b>				<b>Address: 6490 HARMON DRIVE, Sacramento 95831</b>			
<b>Building No:</b> 00B	<b>Room</b> J001	<b>Description</b>	Custodial Closet		<b>Drawing No:</b> 3	<b>Built With Non-Asbestos Materials</b>		
<b>Location</b>	<b>Homogeneous Material</b>	<b>Class</b>	<b>Friable</b>	<b>Material Size</b>	<b>Type of Asbestos</b>	<b>Sample Type</b>	<b>% Asbestos</b>	<b>Sample #</b>

<b>Building No:</b> 00B	<b>Room</b> O008	<b>Description</b>	Classroom		<b>Drawing No:</b> 3	<b>Built With Non-Asbestos Materials</b>		
<b>Location</b>	<b>Homogeneous Material</b>	<b>Class</b>	<b>Friable</b>	<b>Material Size</b>	<b>Type of Asbestos</b>	<b>Sample Type</b>	<b>% Asbestos</b>	<b>Sample #</b>

<b>Building No:</b> 00B	<b>Room</b> O009	<b>Description</b>	Classroom		<b>Drawing No:</b> 3	<b>Built With Non-Asbestos Materials</b>		
<b>Location</b>	<b>Homogeneous Material</b>	<b>Class</b>	<b>Friable</b>	<b>Material Size</b>	<b>Type of Asbestos</b>	<b>Sample Type</b>	<b>% Asbestos</b>	<b>Sample #</b>

<b>Building No:</b> 00B	<b>Room</b> O010	<b>Description</b>	Classroom		<b>Drawing No:</b> 3	<b>Built With Non-Asbestos Materials</b>		
<b>Location</b>	<b>Homogeneous Material</b>	<b>Class</b>	<b>Friable</b>	<b>Material Size</b>	<b>Type of Asbestos</b>	<b>Sample Type</b>	<b>% Asbestos</b>	<b>Sample #</b>

<b>Building No:</b> 00B	<b>Room</b> O011	<b>Description</b>	Classroom		<b>Drawing No:</b> 3	<b>Built With Non-Asbestos Materials</b>		
<b>Location</b>	<b>Homogeneous Material</b>	<b>Class</b>	<b>Friable</b>	<b>Material Size</b>	<b>Type of Asbestos</b>	<b>Sample Type</b>	<b>% Asbestos</b>	<b>Sample #</b>

<b>Building No:</b> 00B	<b>Room</b> O012	<b>Description</b>	Classroom		<b>Drawing No:</b> 3	<b>Built With Non-Asbestos Materials</b>		
<b>Location</b>	<b>Homogeneous Material</b>	<b>Class</b>	<b>Friable</b>	<b>Material Size</b>	<b>Type of Asbestos</b>	<b>Sample Type</b>	<b>% Asbestos</b>	<b>Sample #</b>

<b>Building No:</b> 00B	<b>Room</b> T001	<b>Description</b>	Toilet		<b>Drawing No:</b> 3	<b>Built With Non-Asbestos Materials</b>		
<b>Location</b>	<b>Homogeneous Material</b>	<b>Class</b>	<b>Friable</b>	<b>Material Size</b>	<b>Type of Asbestos</b>	<b>Sample Type</b>	<b>% Asbestos</b>	<b>Sample #</b>

**SACRAMENTO CITY UNIFIED SCHOOL DISTRICT - AHERA 3 YEAR SUSPECT MATERIAL REPORT**

**DATE PRINTED: 7/1/2011 1**

<b>SITE: 350</b>		<b>GENEVIEVE DIDION</b>			<b>Address: 6490 HARMON DRIVE, Sacramento 95831</b>				
<b>Building No:</b>	<b>00B</b>	<b>Room</b>	<b>T002</b>	<b>Description</b>	<b>Toilet</b>		<b>Drawing No:</b>	<b>3</b>	<b>Built With Non-Asbestos Materials</b>
<b>Location</b>	<b>Homogeneous Material</b>	<b>Class</b>	<b>Friable</b>	<b>Material Size</b>	<b>Type of Asbestos</b>	<b>Sample Type</b>	<b>% Asbestos</b>	<b>Sample #</b>	

<b>Building No:</b>	<b>00B</b>	<b>Room</b>	<b>T003</b>	<b>Description</b>	<b>Toilet</b>		<b>Drawing No:</b>	<b>3</b>	<b>Built With Non-Asbestos Materials</b>
<b>Location</b>	<b>Homogeneous Material</b>	<b>Class</b>	<b>Friable</b>	<b>Material Size</b>	<b>Type of Asbestos</b>	<b>Sample Type</b>	<b>% Asbestos</b>	<b>Sample #</b>	

<b>Building No:</b>	<b>00B</b>	<b>Room</b>	<b>T004</b>	<b>Description</b>	<b>Toilet</b>		<b>Drawing No:</b>	<b>3</b>	<b>Built With Non-Asbestos Materials</b>
<b>Location</b>	<b>Homogeneous Material</b>	<b>Class</b>	<b>Friable</b>	<b>Material Size</b>	<b>Type of Asbestos</b>	<b>Sample Type</b>	<b>% Asbestos</b>	<b>Sample #</b>	

<b>Building No:</b>	<b>00B</b>	<b>Room</b>	<b>X001</b>	<b>Description</b>	<b>Library</b>		<b>Drawing No:</b>	<b>3</b>	<b>Built With Non-Asbestos Materials</b>
<b>Location</b>	<b>Homogeneous Material</b>	<b>Class</b>	<b>Friable</b>	<b>Material Size</b>	<b>Type of Asbestos</b>	<b>Sample Type</b>	<b>% Asbestos</b>	<b>Sample #</b>	

**SACRAMENTO CITY UNIFIED SCHOOL DISTRICT - AHERA 3 YEAR SUSPECT MATERIAL REPORT**

**DATE PRINTED: 7/1/2011 1**

<b>SITE: 350</b>	<b>GENEVIEVE DIDION</b>				<b>Address: 6490 HARMON DRIVE, Sacramento 95831</b>			
<b>Building No:</b> 00C	<b>Room</b> O014	<b>Description</b>	<b>Classroom</b>		<b>Drawing No:</b> 3	<b>Built With Non-Asbestos Materials</b>		
<b>Location</b>	<b>Homogeneous Material</b>	<b>Class</b>	<b>Friable</b>	<b>Material Size</b>	<b>Type of Asbestos</b>	<b>Sample Type</b>	<b>% Asbestos</b>	<b>Sample #</b>

<b>Building No:</b> 00C	<b>Room</b> O015	<b>Description</b>	<b>Classroom</b>		<b>Drawing No:</b> 3	<b>Built With Non-Asbestos Materials</b>		
<b>Location</b>	<b>Homogeneous Material</b>	<b>Class</b>	<b>Friable</b>	<b>Material Size</b>	<b>Type of Asbestos</b>	<b>Sample Type</b>	<b>% Asbestos</b>	<b>Sample #</b>

<b>Building No:</b> 00C	<b>Room</b> O016	<b>Description</b>	<b>Classroom</b>		<b>Drawing No:</b> 3	<b>Built With Non-Asbestos Materials</b>		
<b>Location</b>	<b>Homogeneous Material</b>	<b>Class</b>	<b>Friable</b>	<b>Material Size</b>	<b>Type of Asbestos</b>	<b>Sample Type</b>	<b>% Asbestos</b>	<b>Sample #</b>

<b>Building No:</b> 00C	<b>Room</b> O017	<b>Description</b>	<b>Classroom</b>		<b>Drawing No:</b> 3	<b>Built With Non-Asbestos Materials</b>		
<b>Location</b>	<b>Homogeneous Material</b>	<b>Class</b>	<b>Friable</b>	<b>Material Size</b>	<b>Type of Asbestos</b>	<b>Sample Type</b>	<b>% Asbestos</b>	<b>Sample #</b>

<b>Building No:</b> 00C	<b>Room</b> O018	<b>Description</b>	<b>Classroom</b>		<b>Drawing No:</b> 3	<b>Built With Non-Asbestos Materials</b>		
<b>Location</b>	<b>Homogeneous Material</b>	<b>Class</b>	<b>Friable</b>	<b>Material Size</b>	<b>Type of Asbestos</b>	<b>Sample Type</b>	<b>% Asbestos</b>	<b>Sample #</b>

<b>Building No:</b> 00C	<b>Room</b> O019	<b>Description</b>	<b>Classroom</b>		<b>Drawing No:</b> 3	<b>Built With Non-Asbestos Materials</b>		
<b>Location</b>	<b>Homogeneous Material</b>	<b>Class</b>	<b>Friable</b>	<b>Material Size</b>	<b>Type of Asbestos</b>	<b>Sample Type</b>	<b>% Asbestos</b>	<b>Sample #</b>

<b>Building No:</b> 00C	<b>Room</b> O13A	<b>Description</b>	<b>Classroom</b>		<b>Drawing No:</b> 3	<b>Built With Non-Asbestos Materials</b>		
<b>Location</b>	<b>Homogeneous Material</b>	<b>Class</b>	<b>Friable</b>	<b>Material Size</b>	<b>Type of Asbestos</b>	<b>Sample Type</b>	<b>% Asbestos</b>	<b>Sample #</b>

**SACRAMENTO CITY UNIFIED SCHOOL DISTRICT - AHERA 3 YEAR SUSPECT MATERIAL REPORT**

**DATE PRINTED: 7/1/2011 1**

<b>SITE: 350</b>	<b>GENEVIEVE DIDION</b>				<b>Address: 6490 HARMON DRIVE, Sacramento 95831</b>			
<b>Building No:</b> 00C	<b>Room</b> O13B	<b>Description</b>	Classroom		<b>Drawing No:</b> 3	<b>Built With Non-Asbestos Materials</b>		
<b>Location</b>	<b>Homogeneous Material</b>	<b>Class</b>	<b>Friable</b>	<b>Material Size</b>	<b>Type of Asbestos</b>	<b>Sample Type</b>	<b>% Asbestos</b>	<b>Sample #</b>

<b>Building No:</b> 00D	<b>Room</b> I019	<b>Description</b>	Lounge		<b>Drawing No:</b> 2	<b>Built With Non-Asbestos Materials</b>		
<b>Location</b>	<b>Homogeneous Material</b>	<b>Class</b>	<b>Friable</b>	<b>Material Size</b>	<b>Type of Asbestos</b>	<b>Sample Type</b>	<b>% Asbestos</b>	<b>Sample #</b>

<b>Building No:</b> 00D	<b>Room</b> O020	<b>Description</b>	Classroom		<b>Drawing No:</b> 2	<b>Built With Non-Asbestos Materials</b>		
<b>Location</b>	<b>Homogeneous Material</b>	<b>Class</b>	<b>Friable</b>	<b>Material Size</b>	<b>Type of Asbestos</b>	<b>Sample Type</b>	<b>% Asbestos</b>	<b>Sample #</b>

<b>Building No:</b> 00D	<b>Room</b> O021	<b>Description</b>	Classroom		<b>Drawing No:</b> 2	<b>Built With Non-Asbestos Materials</b>		
<b>Location</b>	<b>Homogeneous Material</b>	<b>Class</b>	<b>Friable</b>	<b>Material Size</b>	<b>Type of Asbestos</b>	<b>Sample Type</b>	<b>% Asbestos</b>	<b>Sample #</b>

<b>Building No:</b> 00D	<b>Room</b> O022	<b>Description</b>	Classroom		<b>Drawing No:</b> 2	<b>Built With Non-Asbestos Materials</b>		
<b>Location</b>	<b>Homogeneous Material</b>	<b>Class</b>	<b>Friable</b>	<b>Material Size</b>	<b>Type of Asbestos</b>	<b>Sample Type</b>	<b>% Asbestos</b>	<b>Sample #</b>

<b>Building No:</b> 00D	<b>Room</b> O023	<b>Description</b>	Classroom		<b>Drawing No:</b> 2	<b>Built With Non-Asbestos Materials</b>		
<b>Location</b>	<b>Homogeneous Material</b>	<b>Class</b>	<b>Friable</b>	<b>Material Size</b>	<b>Type of Asbestos</b>	<b>Sample Type</b>	<b>% Asbestos</b>	<b>Sample #</b>

<b>Building No:</b> 00D	<b>Room</b> O024	<b>Description</b>	Classroom		<b>Drawing No:</b> 2	<b>Built With Non-Asbestos Materials</b>		
<b>Location</b>	<b>Homogeneous Material</b>	<b>Class</b>	<b>Friable</b>	<b>Material Size</b>	<b>Type of Asbestos</b>	<b>Sample Type</b>	<b>% Asbestos</b>	<b>Sample #</b>



**SACRAMENTO CITY UNIFIED SCHOOL DISTRICT - AHERA 3 YEAR SUSPECT MATERIAL REPORT**

**DATE PRINTED: 7/1/2011 1**

<b>SITE: 350</b>		<b>GENEVIEVE DIDION</b>			<b>Address: 6490 HARMON DRIVE, Sacramento 95831</b>			
<b>Building No:</b>	<b>00E</b>	<b>Room</b>	<b>O001</b>	<b>Description</b>	<b>4th R Room</b>	<b>Drawing No:</b>	<b>2</b>	<b>Built With Non-Asbestos Materials</b>
<b>Location</b>	<b>Homogeneous Material</b>	<b>Class</b>	<b>Friable</b>	<b>Material Size</b>	<b>Type of Asbestos</b>	<b>Sample Type</b>	<b>% Asbestos</b>	<b>Sample #</b>

<b>Building No:</b>	<b>00F</b>	<b>Room</b>	<b>W001</b>	<b>Description</b>	<b>Music/Band Room</b>	<b>Drawing No:</b>	<b>2</b>	<b>Built With Non-Asbestos Materials</b>
<b>Location</b>	<b>Homogeneous Material</b>	<b>Class</b>	<b>Friable</b>	<b>Material Size</b>	<b>Type of Asbestos</b>	<b>Sample Type</b>	<b>% Asbestos</b>	<b>Sample #</b>

<b>Building No:</b>	<b>00G</b>	<b>Room</b>	<b>C001</b>	<b>Description</b>	<b>Office</b>	<b>Drawing No:</b>	<b>2</b>	<b>Built With Non-Asbestos Materials</b>
<b>Location</b>	<b>Homogeneous Material</b>	<b>Class</b>	<b>Friable</b>	<b>Material Size</b>	<b>Type of Asbestos</b>	<b>Sample Type</b>	<b>% Asbestos</b>	<b>Sample #</b>