



**Business Services**

**Contracts Office**

5735 47th Avenue • Sacramento, CA 95824

(916) 643-2464

*Gerardo Castillo, Chief Business Officer*

*Kimberly Teague, Contract Specialist*

**ADDENDUM NO. 1**

Date: April 18, 2016

Issued by: Sacramento City Unified School District

**Project: Shade Structure at Elder Creek CC**

You are hereby notified of the following changes, clarifications, or modifications to the original Contract Documents, Specifications, and Drawings. This Addendum shall supersede the original project documents, and shall take precedence over anything to the contrary therein. All Addenda shall be acknowledged in the Bid Form. Failure to do so may result in disqualification of the bid. All other conditions remain unchanged.

---

11 drawing items are clouded and tagged with a Delta #1. There are a total of four (4) items included in this addendum.

**General**

1. The General Contractor will relocate the existing temporary chain link fence to the temporary play area as directed by the Program Director.
2. The General Contractor shall reinforce the two exterior doors requiring undercuts per the revised detail 4B/AS3 on the attached sheet A1.
3. All door work is to be performed during the weekend while children are not occupying the room. A door is to be installed prior to children returning on the following Monday.
4. General Contractor is to remove two (2) steel tether ball poles from the play yard. The poles shall be ground down flush with the asphalt with no rough edges.

**END OF ADDENDUM NO. 1**

Attachments

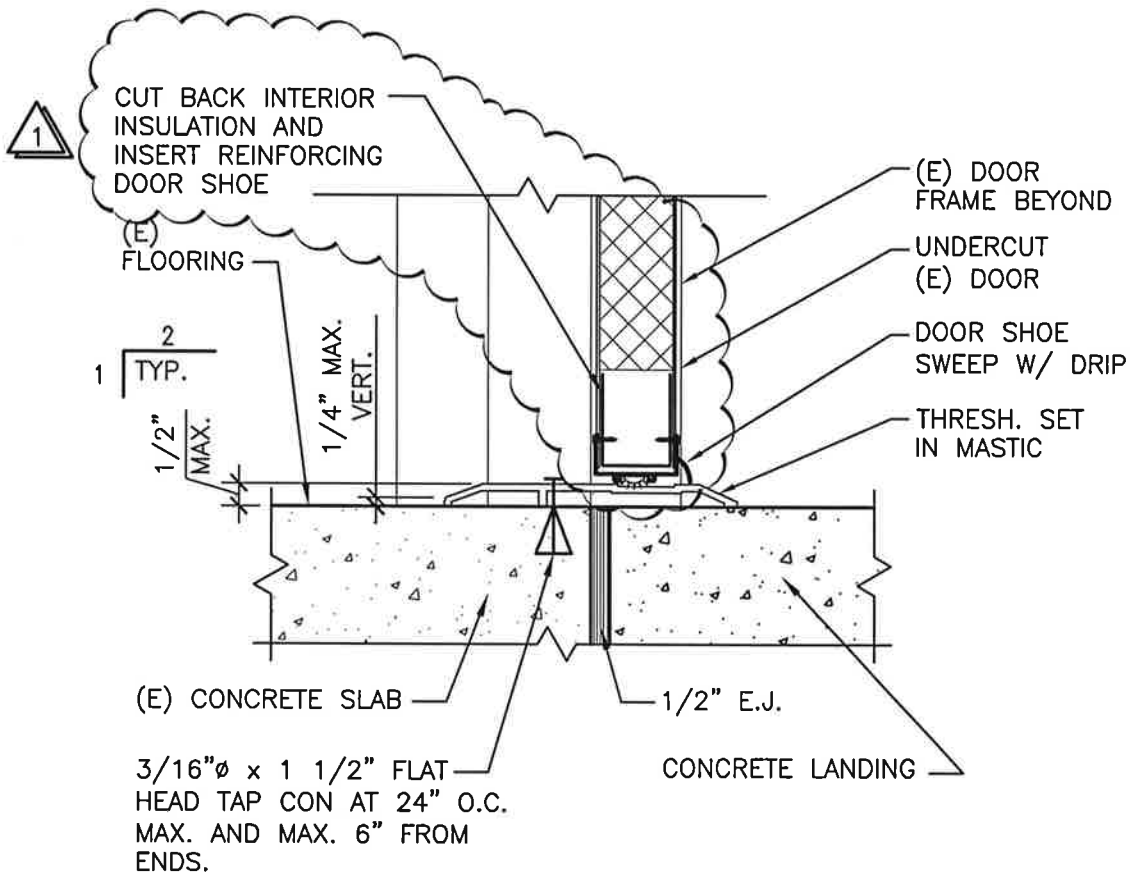

(E) CONCRETE SLAB  
 3/16"Ø x 1 1/2" FLAT  
 HEAD TAP CON AT 24" O.C.  
 MAX. AND MAX. 6" FROM  
 ENDS.

4B  
 AS3

ACCESSIBLE THRESHOLD

FILE: ELDC\_AS3

SCALE: 3"=1'-0"

DSA #02-114954  
 FILE #34-53



**HMR ARCHITECTS**

2130 21st Street  
 Sacramento, CA 95818  
 T 916 736 2724

ELDER CREEK CHILDREN'S CENTER SHADE  
 STRUCTURE

7934 LEMON HILL AVE.  
 SACRAMENTO, CA 95824

JOB NO : 16001  
 DATE : APRIL 18, 2016  
 ISSUED AS :  
 ADDENDUM 1

SHEET NO :  
**A1**