

6/18/2014 10:33:25 AM

CD101-ADD ALT #1

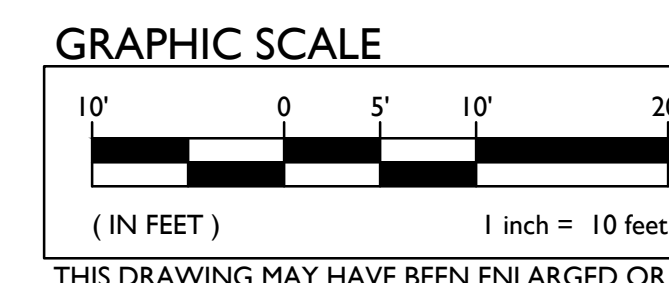

FILENAME: I:\25-046\CIVIL\DWG\OLD 04-09-25\25-046-CD101-CD104.DWG

0 1/4" 1/2" 1" 2" 3" 4" 5" 6" 7" 8" 9" 10" 11" 12" 13" 14" 15" 16" 17" 18" 19" 20" 21" 22" 23" 24" 25" 26" 27" 28" 29" 30" 31" 32" 33" 34" 35" 36" 37" 38" 39" 40" 41" 42" 43" 44" 45" 46" 47" 48" 49" 50" 51" 52" 53" 54" 55" 56" 57" 58" 59" 60" 61" 62" 63" 64" 65" 66" 67" 68" 69" 70" 71" 72" 73" 74" 75" 76" 77" 78" 79" 80" 81" 82" 83" 84" 85" 86" 87" 88" 89" 90" 91" 92" 93" 94" 95" 96" 97" 98" 99" 100" 101" 102" 103" 104" 105" 106" 107" 108" 109" 110" 111" 112" 113" 114" 115" 116" 117" 118" 119" 120" 121" 122" 123" 124" 125" 126" 127" 128" 129" 130" 131" 132" 133" 134" 135" 136" 137" 138" 139" 140" 141" 142" 143" 144" 145" 146" 147" 148" 149" 150" 151" 152" 153" 154" 155" 156" 157" 158" 159" 160" 161" 162" 163" 164" 165" 166" 167" 168" 169" 170" 171" 172" 173" 174" 175" 176" 177" 178" 179" 180" 181" 182" 183" 184" 185" 186" 187" 188" 189" 190" 191" 192" 193" 194" 195" 196" 197" 198" 199" 200" 201" 202" 203" 204" 205" 206" 207" 208" 209" 210" 211" 212" 213" 214" 215" 216" 217" 218" 219" 220" 221" 222" 223" 224" 225" 226" 227" 228" 229" 230" 231" 232" 233" 234" 235" 236" 237" 238" 239" 240" 241" 242" 243" 244" 245" 246" 247" 248" 249" 250" 251" 252" 253" 254" 255" 256" 257" 258" 259" 260" 261" 262" 263" 264" 265" 266" 267" 268" 269" 270" 271" 272" 273" 274" 275" 276" 277" 278" 279" 280" 281" 282" 283" 284" 285" 286" 287" 288" 289" 290" 291" 292" 293" 294" 295" 296" 297" 298" 299" 300" 301" 302" 303" 304" 305" 306" 307" 308" 309" 310" 311" 312" 313" 314" 315" 316" 317" 318" 319" 320" 321" 322" 323" 324" 325" 326" 327" 328" 329" 330" 331" 332" 333" 334" 335" 336" 337" 338" 339" 340" 341" 342" 343" 344" 345" 346" 347" 348" 349" 350" 351" 352" 353" 354" 355" 356" 357" 358" 359" 360" 361" 362" 363" 364" 365" 366" 367" 368" 369" 370" 371" 372" 373" 374" 375" 376" 377" 378" 379" 380" 381" 382" 383" 384" 385" 386" 387" 388" 389" 390" 391" 392" 393" 394" 395" 396" 397" 398" 399" 400" 401" 402" 403" 404" 405" 406" 407" 408" 409" 410" 411" 412" 413" 414" 415" 416" 417" 418" 419" 420" 421" 422" 423" 424" 425" 426" 427" 428" 429" 430" 431" 432" 433" 434" 435" 436" 437" 438" 439" 440" 441" 442" 443" 444" 445" 446" 447" 448" 449" 450" 451" 452" 453" 454" 455" 456" 457" 458" 459" 460" 461" 462" 463" 464" 465" 466" 467" 468" 469" 470" 471" 472" 473" 474" 475" 476" 477" 478" 479" 480" 481" 482" 483" 484" 485" 486" 487" 488" 489" 490" 491" 492" 493" 494" 495" 496" 497" 498" 499" 500" 501" 502" 503" 504" 505" 506" 507" 508" 509" 510" 511" 512" 513" 514" 515" 516" 517" 518" 519" 520" 521" 522" 523" 524" 525" 526" 527" 528" 529" 530" 531" 532" 533" 534" 535" 536" 537" 538" 539" 540" 541" 542" 543" 544" 545" 546" 547" 548" 549" 550" 551" 552" 553" 554" 555" 556" 557" 558" 559" 560" 561" 562" 563" 564" 565" 566" 567" 568" 569" 570" 571" 572" 573" 574" 575" 576" 577" 578" 579" 580" 581" 582" 583" 584" 585" 586" 587" 588" 589" 590" 591" 592" 593" 594" 595" 596" 597" 598" 599" 600" 601" 602" 603" 604" 605" 606" 607" 608" 609" 610" 611" 612" 613" 614" 615" 616" 617" 618" 619" 620" 621" 622" 623" 624" 625" 626" 627" 628" 629" 630" 631" 632" 633" 634" 635" 636" 637" 638" 639" 640" 641" 642" 643" 644" 645" 646" 647" 648" 649" 650" 651" 652" 653" 654" 655" 656" 657" 658" 659" 660" 661" 662" 663" 664" 665" 666" 667" 668" 669" 670" 671" 672" 673" 674" 675" 676" 677" 678" 679" 680" 681" 682" 683" 684" 685" 686" 687" 688" 689" 690" 691" 692" 693" 694" 695" 696" 697" 698" 699" 700" 701" 702" 703" 704" 705" 706" 707" 708" 709" 710" 711" 712" 713" 714" 715" 716" 717" 718" 719" 720" 721" 722" 723" 724" 725" 726" 727" 728" 729" 730" 731" 732" 733" 734" 735" 736" 737" 738" 739" 740" 741" 742" 743" 744" 745" 746" 747" 748" 749" 750" 751" 752" 753" 754" 755" 756" 757" 758" 759" 760" 761" 762" 763" 764" 765" 766" 767" 768" 769" 770" 771" 772" 773" 774" 775" 776" 777" 778" 779" 780" 781" 782" 783" 784" 785" 786" 787" 788" 789" 790" 791" 792" 793" 794" 795" 796" 797" 798" 799" 800" 801" 802" 803" 804" 805" 806" 807" 808" 809" 810" 811" 812" 813" 814" 815" 816" 817" 818" 819" 820" 821" 822" 823" 824" 825" 826" 827" 828" 829" 830" 831" 832" 833" 834" 835" 836" 837" 838" 839" 840" 841" 842" 843" 844" 845" 846" 847" 848" 849" 850" 851" 852" 853" 854" 855" 856" 857" 858" 859" 860" 861" 862" 863" 864" 865" 866" 867" 868" 869" 870" 871" 872" 873" 874" 875" 876" 877" 878" 879" 880" 881" 882" 883" 884" 885" 886" 887" 888" 889" 890" 891" 892" 893" 894" 895" 896" 897" 898" 899" 900" 901" 902" 903" 904" 905" 906" 907" 908" 909" 910" 911" 912" 913" 914" 915" 916" 917" 918" 919" 920" 921" 922" 923" 924" 925" 926" 927" 928" 929" 930" 931" 932" 933" 934" 935" 936" 937" 938" 939" 940" 941" 942" 943" 944" 945" 946" 947" 948" 949" 950" 951" 952" 953" 954" 955" 956" 957" 958" 959" 960" 961" 962" 963" 964" 965" 966" 967" 968" 969" 970" 971" 972" 973" 974" 975" 976" 977" 978" 979" 980" 981" 982" 983" 984" 985" 986" 987" 988" 989" 990" 991" 992" 993" 994" 995" 996" 997" 998" 999" 1000

MATCHLINE - SEE SHEET CG103

SUBGRADE PREPARATION

1. FOLLOWING SITE DEMOLITION ACTIVITIES:

FOR AREAS TO RECEIVE CONCRETE AND ASPHALT PAVING, EXCAVATE DOWN TO ROUGH SUBGRADE ELEVATION, SCARIFY THE EXISTING SOILS TO A MINIMUM DEPTH OF 8 INCHES, MOISTURE CONDITION TO AT LEAST 2 PERCENT ABOVE THE OPTIMUM MOISTURE AND COMPACT TO AT LEAST 90 PERCENT OF THE MAXIMUM DRY DENSITY DETERMINED BY THE ASTM D1557 TEST METHOD. UPPER 8 INCHES OF SUBGRADE BENEATH ASPHALT PAVEMENT SHALL BE COMPACTED TO 95 PERCENT.

GRADING NOTES

1. MATCH EXISTING GRADE/ELEVATION.
2. CONSTRUCT CONCRETE CURB PER (2) C501
3. CONSTRUCT 12" WIDE CONCRETE BAND PER (5) C501
4. CONSTRUCT ACCESSIBLE CURB RAMP PER (3) C501
5. TURF/MULCH DAMAGED AND/OR REMOVED BY CONSTRUCTION ACTIVITIES SHALL BE REPLACED WITH SOD AND/OR MATCHING MULCH. SPRINKLERS REMOVED/DAMAGED SHALL BE REPLACED TO ALLOW FOR PROPER IRRIGATION COVERAGE.

DRAINAGE NOTES

31. CONSTRUCT DROP INLET PER (11) C501
32. PLACE 8" STORM DRAIN PER (12) C501
33. CONNECT TO EXISTING DROP INLET. FIELD VERIFY EXACT DEPTH PRIOR TO TRENCHING.

LIONAKIS

2025 Nineteenth Street
Sacramento, CA 95818
P 916.558.1900
www.lionakis.com

CONSULTANT

WCE

WARREN CONSULTING ENGINEERS, INC.
1117 WINDFIELD WAY, SUITE 110
EL DORADO HILLS, CA 95762 | (916) 985-1870

SEAL



PROJECT
ABRAHAM LINCOLN ELEMENTARY
SCHOOL - FENCING & PC SHADE
STRUCTURE
3324 GLENMOOR DR
SACRAMENTO, CA 95827

CLIENT
SACRAMENTO CITY UNIFIED SCHOOL DISTRICT

5735 47th Ave Sacramento, CA 95824

ISSUED

MARK	DATE	DESCRIPTION
DSA	04/09/2025	DSA APPROVAL
ADD01	05/12/2025	ADDENDUM #01

MANAGEMENT

LIONAKIS PROJECT NO. 025013
COPYRIGHT: DSA APPROVAL LIONAKIS 2024

AGENCY

TITLE

GRADING PLAN

SHEET

CG101-ADD ALT #1

GRAPHIC SCALE

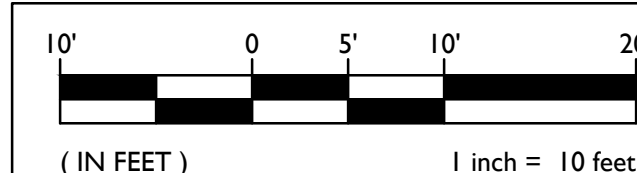

THIS DRAWING MAY HAVE BEEN ENLARGED OR REDUCED.

FILENAME: I:\25-046\CIVIL\DWG\OLD 04-09-25\25-046-CG101-CG104.DWG

IF THIS SHEET IS NOT 30"x42", IT IS A REDUCED PRINT - SCALE ACCORDINGLY
0 1/4" 1/2" 1"
1:014133_BML_A-MASTER_R1_V1_CENTRAL_mike boss.mxd
6/19/2014 10:33:25 AM

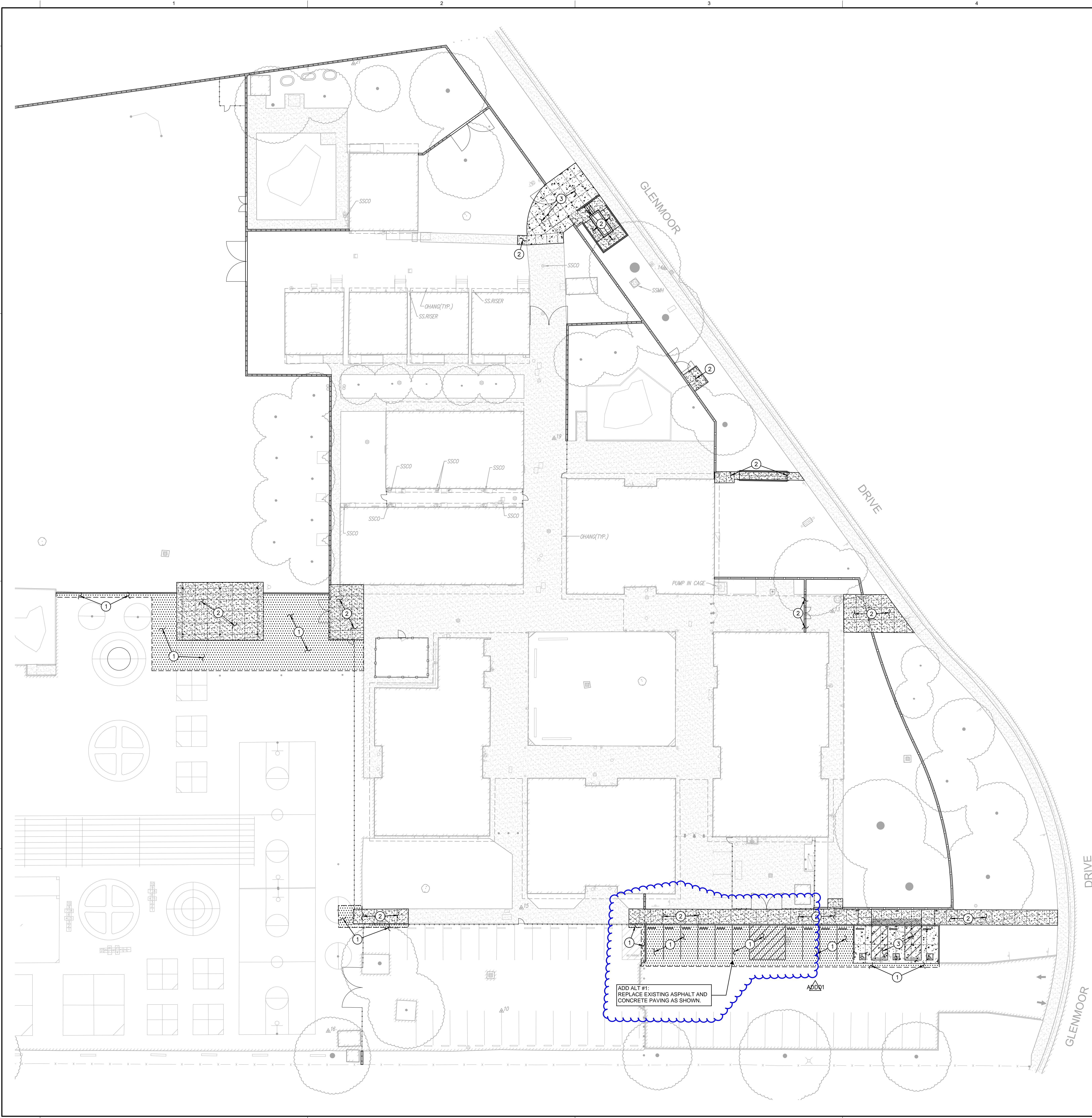

PAVING GENERAL NOTES:

- ALL NEW ASPHALT PAVING TO BE PROVIDED WITH SEALCOAT PER SPECIFICATIONS.
- PRIOR TO NEW SEALCOAT ON EXISTING ASPHALT SURFACES, FILL ALL CRACKS 1/4" INCHES OR WIDER WITH AN APPROVED CRACK FILLER.
- SLOPE IN ACCESSIBLE STALLS AND UNLOAD ZONES SHALL NOT EXCEED 1.9% IN ANY DIRECTION.
- SLOPE OF FINISHED PAVING TO BE 1% MINIMUM FOR ASPHALT, 0.5% MINIMUM FOR CONCRETE AND THE MAXIMUM SLOPE SHALL BE AS FOLLOWS:
CROSS SLOPE PERPENDICULAR TO PATH OF TRAVEL 1.9%
DIRECTION OF TRAVEL - 4.9%
RAMP IN DIRECTION OF TRAVEL - 8.0%
PLAZA 1.9% - IN ANY DIRECTION
- ADJUST TO FINISH GRADE ALL UTILITY BOXES, FRAMES, COVERS, SLEEVES, POST HOLES GRATES, ETC. FOUND IN AREA OF WORK, WHETHER SHOWN OR NOT. CLEAN OR REPLACE AS NECESSARY TO ENSURE PROPER SEATING.

PAVING LEGEND

- 1 TYPE 1 PAVING**
PLACE 3" AC OVER 12" CLASS II AB ON A TENSAR BX1100 GEOGRID ON SUBGRADE COMPACTED PER PLAN AND PROJECT SPECIFICATIONS. PROVIDE 2 APPLICATIONS OF SEAL COAT ON NEW PAVING.
- 2 TYPE 2 PAVING**
PLACE 5" PCC OVER 12" AB WITH #4 BAR AT 24" O.C.E.W. ON SUBGRADE COMPACTED PER PLAN AND PROJECT SPECIFICATIONS.
- 3 TYPE 3 PAVING**
PLACE 6" PCC OVER 12" AB WITH #4 BAR AT 18" O.C.E.W. ON SUBGRADE COMPACTED PER PLAN AND PROJECT SPECIFICATIONS.

GRAPHIC SCALE

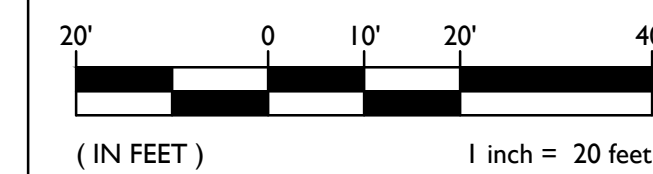

THIS DRAWING MAY HAVE BEEN ENLARGED OR REDUCED.

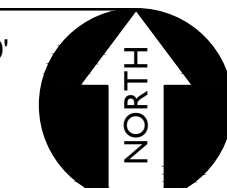

LIONAKIS

2025 Nineteenth Street
Sacramento, CA 95818
P 916.558.1900
www.lionakis.com

CONSULTANT



WARREN CONSULTING ENGINEERS, INC.
1117 WINDFIELD WAY, SUITE 110
EL DORADO HILLS, CA 95762 | (916) 985-1870

SEAL



PROJECT
ABRAHAM LINCOLN ELEMENTARY
SCHOOL - FENCING & PC SHADE
STRUCTURE
3324 GLENMOOR DR
SACRAMENTO, CA 95827

CLIENT
SACRAMENTO CITY UNIFIED SCHOOL DISTRICT
5735 47th Ave Sacramento, CA 95824

ISSUED

MARK	DATE	DESCRIPTION
DSA	04/09/2025	DSA APPROVAL
ADD01	05/12/2025	ADDENDUM #01

MANAGEMENT

LIONAKIS PROJECT NO: 025013
COPYRIGHT: LIONAKIS 2024

AGENCY

TITLE

PAVING PLAN

SHEET

CP101-ADD ALT #1

IF THIS SHEET IS NOT 30"x42", IT IS A REDUCED PRINT. SCALE ACCORDINGLY.

0 1/4" 1/2" 1"

0 1/4" 1/2" 1"

1:014132_BML_A-MASTER_R1_V1_CENTRAL_mike.bossert

6/19/2024 10:33:25 AM

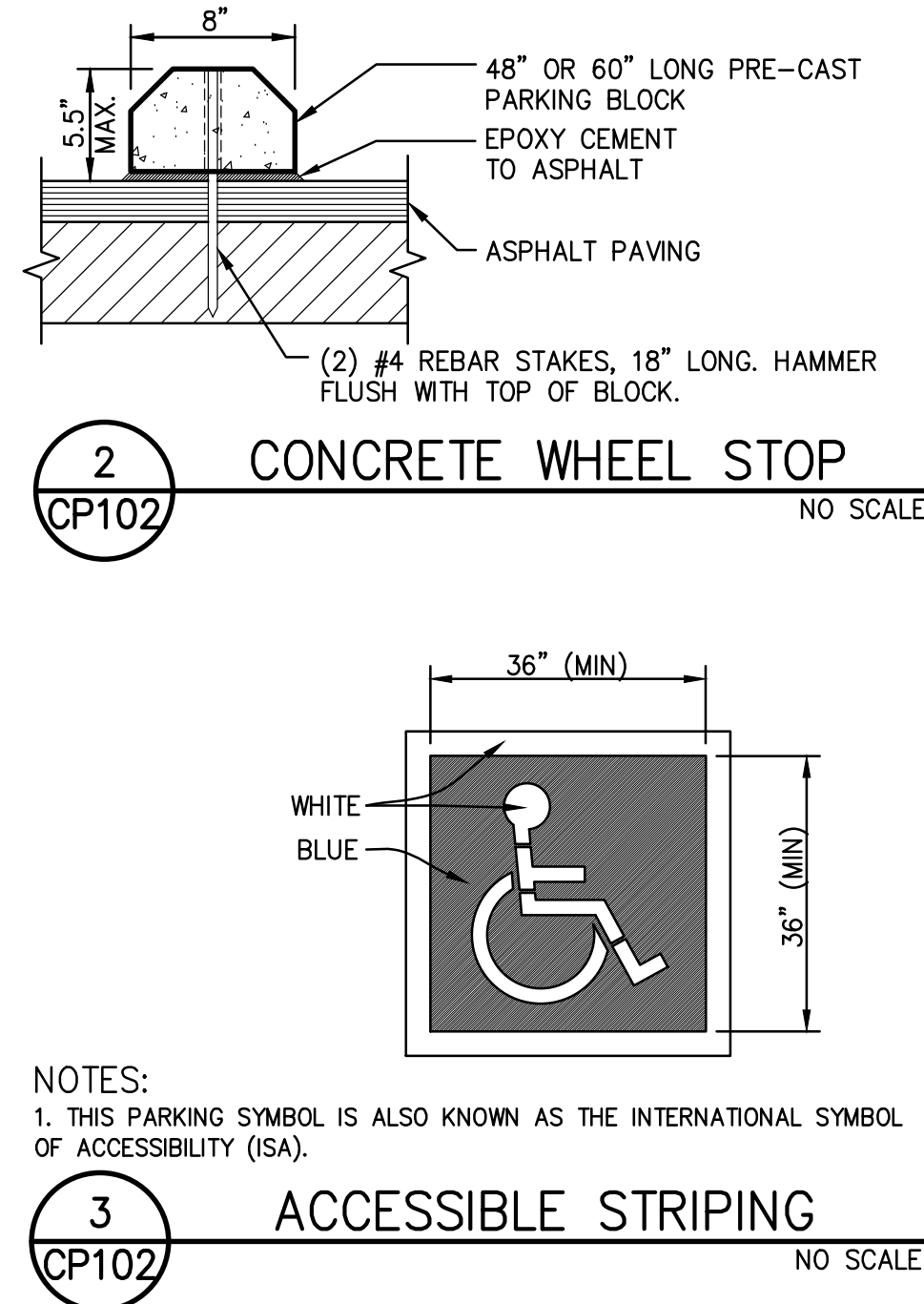
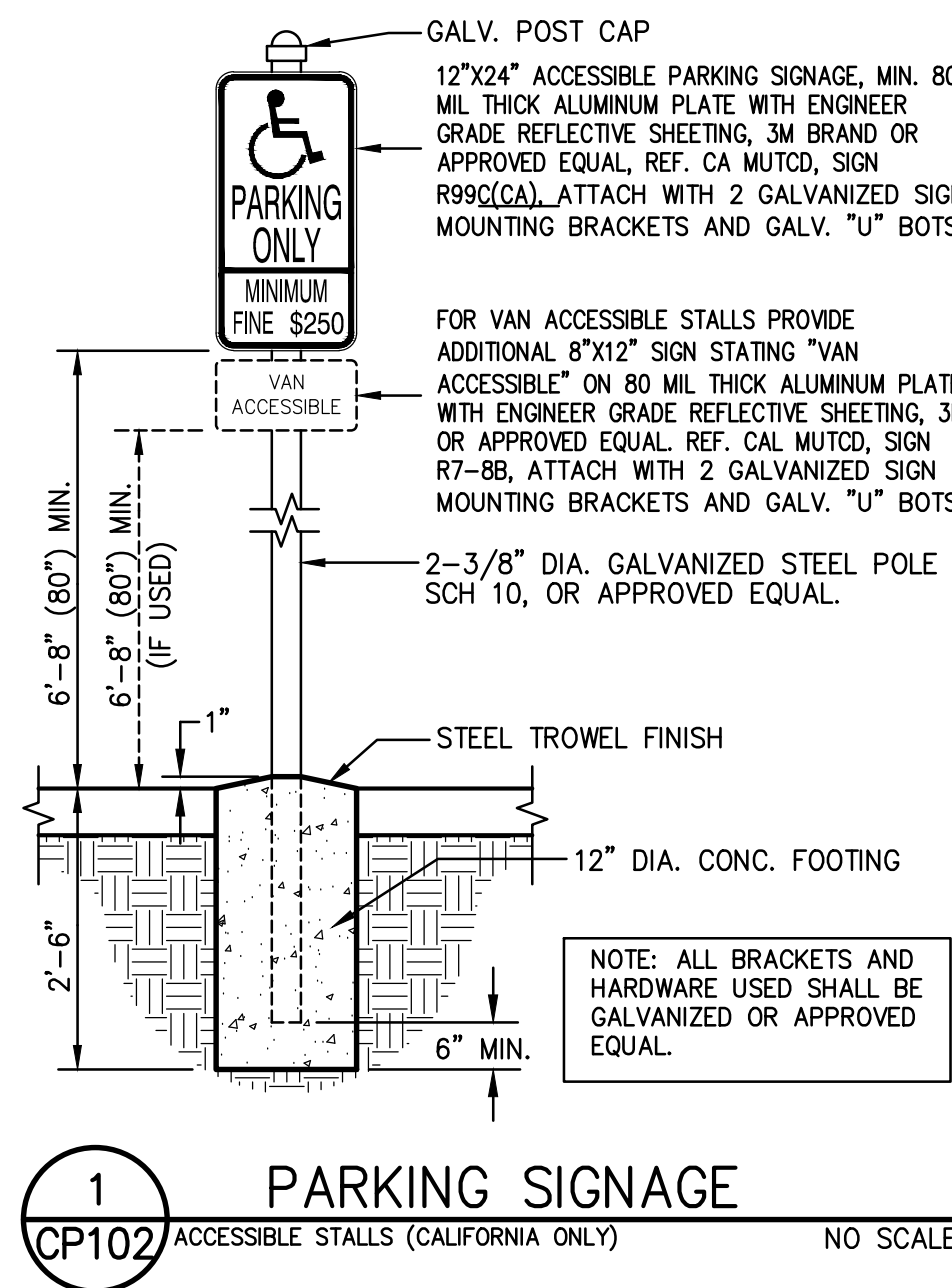
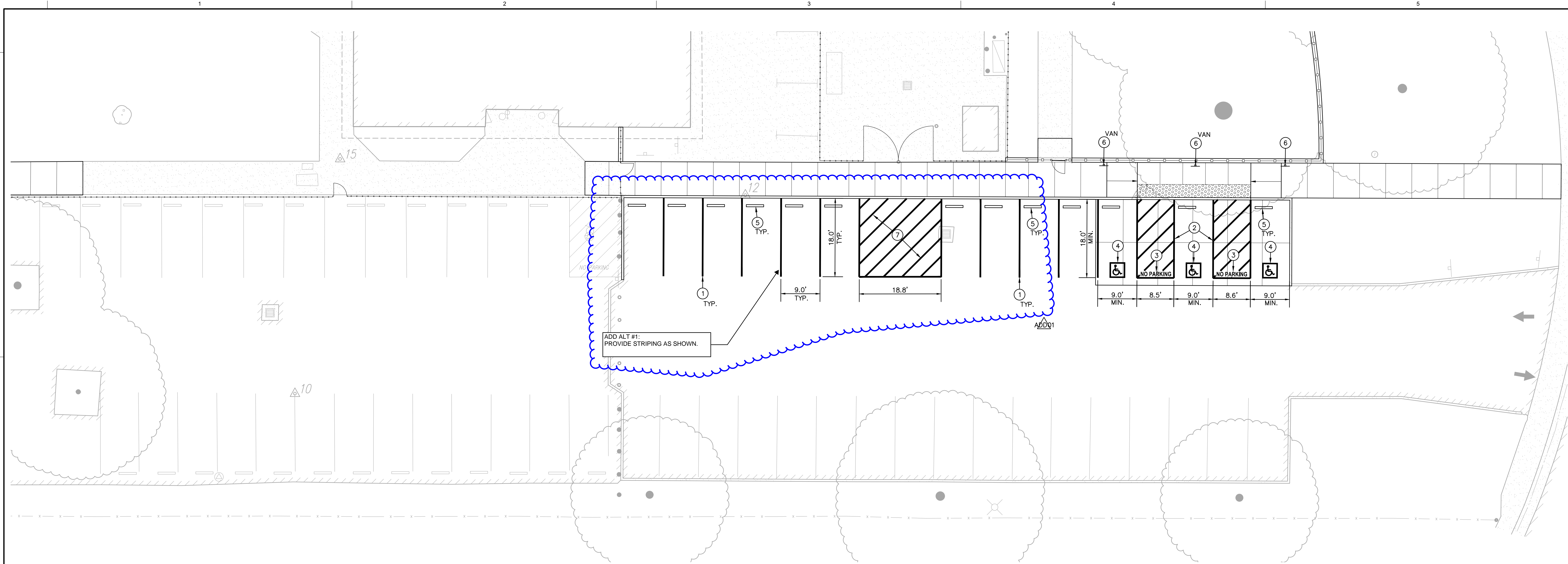

PARKING LOT STRIPING/SIGNAGE NOTES

1. PAINT 4" WIDE WHITE STRIPING IN LAYOUT AND PER THE DIMENSIONS SHOWN.
2. PAINT 4" WIDE BLUE STRIPING AROUND PERIMETER OF ACCESSIBLE LOADING AREA WITH BLUE CROSS HATCH STRIPING. STRIPES SHALL BE 4" WIDE AND 36" O.C. AND 30' FROM PERPENDICULAR WITH PERIMETER STRIPING.
3. PAINT 12" HIGH WHITE LETTERING EXPRESSING "NO PARKING".
4. PAINT INTERNATIONAL SYMBOL FOR ACCESSIBILITY PARKING STALL SYMBOL IN ACCORDANCE WITH THE DIMENSIONS AND COLORING SHOWN IN THE PROVIDED DETAIL.
5. PLACE 48" LONG CONCRETE WHEEL STOP PER THE DETAIL PROVIDED.
6. INSTALL ACCESSIBLE PARKING SIGN PER THE DETAIL PROVIDED. WHERE SHOWN ON PLAN AS "VAN" ACCESSIBLE STALL, PROVIDE EXTRA "VAN ACCESSIBLE" SIGN AS SHOWN IN DETAIL. POST MAY BE OMITTED WHERE FENCE IS PRESENT TO MOUNT SIGN AS SHOWN. MOUNT AT HEIGHT PER DETAIL WITH APPROPRIATE STAINLESS SCREWS.
7. PAINT 4" WHITE STRIPING AROUND PERIMETER OF AREA WITH WHITE CROSS HATCH STRIPING. STRIPES SHALL BE 4" WIDE AND 36" O.C. AND 30' FROM PERPENDICULAR WITH PERIMETER STRIPING.

GRAPHIC SCALE

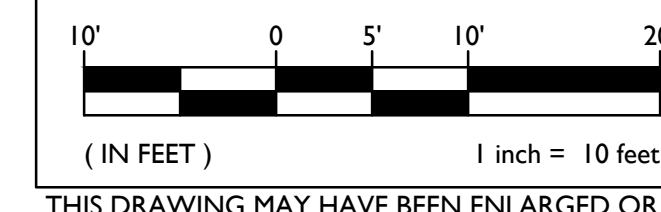

LIONAKIS

2025 Nineteenth Street
Sacramento, CA 95818
P 916.558.1900
www.lionakis.com

CONSULTANT



WARREN CONSULTING ENGINEERS, INC.
1117 WINDFIELD WAY, SUITE 110
EL DORADO HILLS, CA 95762 | (916) 385-1870

SEAL



PROJECT
**ABRAHAM LINCOLN ELEMENTARY
SCHOOL - FENCING & PC SHADE
STRUCTURE**
3324 GLENMOOR DR
SACRAMENTO, CA 95827

CLIENT
SACRAMENTO CITY UNIFIED SCHOOL DISTRICT

5735 47th Ave Sacramento, CA 95824

ISSUED

MARK	DATE	DESCRIPTION
DSA	04/09/2025	DSA APPROVAL
ADD01	05/12/2025	ADDENDUM #01

MANAGEMENT

LIONAKIS PROJECT NO. 025013
COPYRIGHT: LIONAKIS 2024

AGENCY

TITLE

**STRIPING AND
SIGNAGE PLAN**

SHEET

CP102-ADD ALT #1